

2011 Summer Conference
ONE GOAL: BUILDING
THE FUTURE TOGETHER
“PUTTING FAMILIES AND
CHILDREN FIRST”



July 20-22, 2011
Hyatt Regency at Tampa Center
Tampa, Florida



**2011 SUMMER CONFERENCE
 ONE GOAL: BUILDING THE FUTURE TOGETHER
 “PUTTING FAMILIES AND CHILDREN FIRST”**

Table of Contents

| | |
|--|------------|
| Sponsors and Planning Committee..... | 2 |
| Conference At-A-Glance..... | 3-6 |
| Program Tracks At-A-Glance..... | 7-13 |
| Performance Standards and Domains..... | 14 |
| Core Competencies..... | 14 |
| Nancy D. Thomas Award Recipients..... | 15-17 |
| Conference Program..... | 18-84 |
| Wednesday, July 20..... | 18-26 |
| Opening General Session..... | 19 |
| Concurrent Presentations..... | 20-26 |
| Thursday, July 21 | |
| Concurrent Presentations..... | 27-66 |
| Research Luncheon..... | 42 |
| Friday, July 22 | |
| Concurrent Presentations..... | 67-83 |
| Closing General Session..... | 84 |
| Commercial Exhibitors..... | 85-86 |
| Program Presenters..... | 87-88 |
| Hyatt Meeting Rooms Locator Map..... | 89 |
| 2012 Conference Date..... | Back Cover |

2011 CONFERENCE SPONSORS

Creative Center for Childhood Research & Training
Association of Early Learning Coalitions
Child Development & Education Alliance
Children's Forum
Florida Association for the Education of Young Children
Florida Agency for Workforce Innovation/Office of Early Learning
Florida Department of Children & Families
Florida Department of Education
Florida Department of Health
Florida Family Child Care Home Association
Florida Early Childhood Association
Florida Head Start Association
Florida Head Start State Collaboration Office
Florida Institute of Education at University of North Florida
Nemours Brightstart!
The Early Childhood Initiative Foundation
Training & Technical Assistance Services at Western Kentucky University
United Way of Florida

2011 PLANNING COMMITTEE

Theodore Granger
Chair, One Goal Summer Conference

Frankie Allen
Conference Coordinator

Phyllis Kalifeh
Children's Forum

Susan Arnold
Florida Department of Children & Families

Ann Levy
Early Childhood Consultant

George Brown
Florida Department of Children & Families

Lou Ann Long
Children's Forum/Central Directory

Lilli Copp
Florida Head Start State Collaboration Office

Pamela C. Phelps
Creative Center for Research & Training

Ruth Elswood
Florida Parental Information & Resource Center at
University of South Florida

Haylie Smith
Florida Department of Health

Carole D. Fiore
Training & Library Consultant

Liza Smith
Florida Department of Health

Alisa Ghazvini
Training & Technical Assistance Services at Western
Kentucky University

Carole West
Florida Department of Education

Stacy Howard
Florida Agency for Workforce Innovation/
Office of Early Learning

2011 SUMMER CONFERENCE

Wednesday, July 20, 2011

CONFERENCE-AT-A-GLANCE

| | | |
|--|--|----------------|
| 10:00 A.M.-4:45 P.M. | EDUCATIONAL PROGRAMS & SERVICES EXHIBITS | Regency I |
| 12:00 NOON-12:45 P.M. | FIRST TIMERS' ORIENTATION SESSION | Regency V |
| 1:00 P.M.-3:15 P.M. | OPENING GENERAL SESSION Keynote Speaker: Naomi Haines Griffith | Regency II |
| 3:30 P.M.-5:00 P.M. | CONCURRENT PRESENTATIONS | |
| 1. Strengthening Families - A Challenge In Collaboration | Collaboration | Regency V |
| 2. More Than Plastic Bugs & Pinecones! Embedding Science In Classroom | Dev Appropriate Curriculum | Regency VII |
| 3. Federal Landscape: Assessing Opportunities For Early Care & Education | Public Policy & Advocacy | Buccaneer B |
| 4. Creating A Culture Of Safety | Management & Leadership | Buccaneer C |
| 5. A New Tool For Measuring Quality In Family Child Care Homes | Management & Leadership | Buccaneer D |
| 6. 101 Ways To Use A Word Wall: But Who's Counting? | Dev Appropriate Curriculum | Esplanade I |
| 7. Si, I'm learning In Two Languages! Dual Language Classroom Strategies | Cultural Diversity/Multicultural Ed | Esplanade II |
| 8. How To Make Those Kindergarten Teachers CRAZY About Our Kids | Child Growth & Development | Esplanade III |
| 9. Opening The Cover (<i>Session Repeated, #20</i>) | Dev Appropriate Curriculum | Garrison I-III |
| 10. Serving To Learn, Learning To Serve | Dev Appropriate Curriculum | City Center |
| 5:00 P.M.-6:00 P.M. | "REDISCOVERING YOUR CHILD" | Regency II |
| 6:00 P.M.-10:00 P.M. | FREE SHUTTLE TO INTERNATIONAL PLAZA MALL | |

2011 SUMMER CONFERENCE

Thursday, July, 21, 2011

CONFERENCE-AT-A-GLANCE

8:00 A.M.-10:00 A.M. **COFFEE BREAK** Regency I

8:00 A.M.-5:00 P.M. **COMMERCIAL EXHIBITS** Regency I

8:30 A.M.-10:00 A.M. **CONCURRENT PRESENTATIONS**

| | | |
|--|----------------------------------|----------------|
| 11. When Budgets Shrink-Where Do We Go And How Do We Get There? | Management & Leadership | Regency VI |
| 12. Do You Have Enough:Arranging Play Environment Positive Experiences | Child Growth & Development | Regency V |
| 13. Phonological Fun: Moving Beyond Beginning Sound And Rhyming Words | Dev Appropriate Curriculum | Regency VII |
| 14. Managing Time Before It Manages You | Management & Leadership | Buccaneer B |
| 15. Prof Dev & Quality Rating Improvement Systems: WorkingTogether | Management & Leadership | Buccaneer C |
| 16. Overview of Epilepsy | Special Needs & Inclusion | Buccaneer D |
| 17. Supporting Educational Benchmarks Through Playful Afterschool Activities | Dev Appropriate Curriculum | Esplanade I |
| 18. Identifying And Reducing Inappropriate Behavior | Mental Health/Managing Behaviors | Esplanade II |
| 19. Family Projects: A Home-School Connection! | Family Involvement & Support | Esplanade III |
| 20. Opening The Cover (<i>Session Repeated</i>) | Dev Appropriate Curriculum | Garrison I-III |
| 21. FL Early Care & Education Professional Dev Initiative: A Progress Report | Management & Leadership | Ybor |
| 22. Making The Most Of Every Minute In The Preschool Classroom | Dev Appropriate Curriculum | City Center |

10:15 A.M.-11:45 A.M. **CONCURRENT PRESENTATIONS**

| | | |
|--|------------------------------|---------------|
| 23. More Than Recess:A Successful Outdoor Classroom In Southern Climate | Child Growth & Development | Regency V |
| 24. You Should KNOW Better! Helping Children Accept Responsibility | Health, Safety & Nutrition | Regency VI |
| 25. Obesity In Children: Are You The Problem Or The Solution? | Health, Safety & Nutrition | Regency VII |
| 26. 2011 State And Federal Legislative Review | Public Policy & Advocacy | Buccaneer B |
| 27. Leadership In Action - How To Walk Your Talk | Management & Leadership | Buccaneer D |
| 28. Literacy Enhance Early Readers :Provide Playful Literacy Opportunities | Dev Appropriate Curriculum | Esplanade I |
| 29. CCR&R Is The Front Door To Family Services | Family Involvement & Support | Esplanade II |
| 30. Early Signs Of Autism | Special Needs & Inclusion | Esplanade III |
| 31. Teaching How Children Learn - Not How You Teach Them | Child Growth & Development | Garrison I-II |
| 32. All The Write Moves | Dev Appropriate Curriculum | City Center |

12:00 NOON-1:15 P.M. **RESEARCH PRESENTATION** Regency II
Keynote Speaker: Dr. Daryl B. Greenfield
(Includes Lunch, Ticket Required)

2011 SUMMER CONFERENCE

Thursday, July, 21, 2011

1:30 P.M.-2:30 P.M.

CONCURRENT PRESENTATIONS

| | | |
|--|-------------------------------------|----------------|
| 33. Sensory Art Experiences For Infants & Toddlers | Dev Appropriate Curriculum | Regency V |
| 34. Voluntary Prekindergarten (VPK) Assessment Overview | Screen/Assess/Evaluations | Regency VI |
| 35. Science: Before And AFTER! | Dev Appropriate Curriculum | Regency VII |
| 36. Educating Our Practitioners Is Just A Click Away! | Management & Leadership | Buccaneer A |
| 37. Book Nook | Child Growth & Development | Buccaneer B |
| 38. Communicating With The English Language Learner In Your Care | Cultural Diversity/Multicultural Ed | Buccaneer C |
| 39. KidVision VPK - VPK Standards Professional Dev & Classroom Tools | Dev Appropriate Curriculum | Buccaneer D |
| 40. KidSafe - Information All Teachers Need To Know | Health, Safety & Nutrition | Esplanade I |
| 41. Bridging The Gap | Family Involvement/Collaboration | Esplanade II |
| 42. The Journey To Quality | Management & Leadership | Esplanade III |
| 43. Let's Make Some Music! | Special Needs/Dev App Curriculum | Garrison I-III |
| 44. T.E.A.C.H. And WAGES: Hand-In-Hand Programs Encouraging Prof Dev | Management & Leadership | Ybor |
| 45. Chillers, Thrillers And Time Fillers | Dev Appropriate Curriculum | City Center |

2:45 P.M.-3:45 P.M.

CONCURRENT PRESENTATIONS

| | | |
|--|----------------------------------|----------------|
| 46. Character By The Book | Dev Appropriate Curriculum | Regency II |
| 47. It's All About Teaching - Strategies To Reduce Challenging Behaviors | Mental Health/Managing Behaviors | Regency V |
| 48. Florida Kindergarten Readiness Screener (FLKRS) & VPK Readiness Rate | Screen/Assess/Evaluations | Regency VI |
| 49. Promoting Physical Activity Among Young Children With Autism | Special Needs & Inclusion | Regency VII |
| 50. A Prime Time Family Experience! | Family Involvement/Collaboration | Buccaneer A |
| 51. Bringing The Story To Life! | Dev Appropriate Curriculum | Buccaneer B |
| 52. Early Learning Information System (ELIS) Overview And Focus Group | Public Policy & Advocacy | Buccaneer C |
| 53. Training Practitioners In Effective Professional Development | Management & Leadership | Buccaneer D |
| 54. Using Self-Assessment To Close The Loop | Management & Leadership | Esplanade I |
| 55. Licensing Counselor's Role Ensuring Health/Safety In Child Care Settings | Health, Safety & Nutrition | Esplanade II |
| 56. Inclusion & The Arts Using "Start With The Arts" | Dev Appropriate Curriculum | Esplanade III |
| 57. Let's Make Some Music! | Special Needs/Dev App Curriculum | Garrison I-III |
| 58. What's A TATS? | Special Needs & Inclusion | Ybor |
| 59. Movin Up! Movin Out! M-o-o-vin All About! | Child Growth & Development | City Center |

4:00 P.M.-5:00 P.M.

CONCURRENT PRESENTATIONS

| | | |
|--|----------------------------------|----------------|
| 60. Making Music Matter | Dev Appropriate Curriculum | Regency II |
| 61. Achieving Cohesiveness With Ease | Management & Leadership | Regency V |
| 62. Voluntary Prekindergarten Professional Development/Teacher Resources | Management & Leadership | Regency VI |
| 63. If I Can't Picture It, I Can't Understand It: Effective Use Of Visual Supports | Mental Health/Managing Behaviors | Regency VII |
| 64. A Guide To The Florida Child Care Staff Credential | Management & Leadership | Buccaneer A |
| 65. Creating Confident Writers | Dev Appropriate Curriculum | Buccaneer B |
| 66. Early Learning Partners Initiative-What's In It for Children? | Screen/Assess/Evaluations | Buccaneer C |
| 67. Early Recognition, Early Success: Overview Of Early Steps | Screen/Assess/Evaluations | Buccaneer D |
| 68. Parents As Teachers-Ahead Of Curve On Evidence-Based Home Visiting | Family Involvement & Support | Esplanade I |
| 69. Identifying/Nurturing Potential In Young Children With Dual Languages | Special Needs & Inclusion | Esplanade II |
| 70. Islands Of Excellence-Do&Learn Or Sit&Get? Prof Dev To Enhance Quality | Management & Leadership | Esplanade III |
| 71. One Book Across The Curriculum | Dev Appropriate Curriculum | Garrison I-III |
| 72. Family Providers Focus On Literacy | Child Growth & Development | Ybor |

5:00 P.M.-10:00 P.M.

FREE SHUTTLE TO WESTSHORE PLAZA MALL

8:00 P.M.-11:00 P.M.

"COME ALIVE WITH MUSIC"

Regency II

2011 SUMMER CONFERENCE

Friday, July 22, 2011

CONFERENCE-AT-A-GLANCE

| | | | |
|---|---------------------------------------|--|----------------|
| 8:00 A.M.-10:00 A.M. | COFFEE BREAK | | Regency I |
| 8:00 A.M.-11:45 A.M. | COMMERCIAL EXHIBITS | | Regency I |
| 8:30 A.M.-10:00 A.M. | CONCURRENT PRESENTATIONS | | |
| 73. Making The Body-Brain Connection In Teaching & Learning | Child Growth & Development | | Regency II |
| 74. More Than Just Talk: Early Communication & Play | Special Needs/Child Growth & Dev | | Regency V |
| 75. Early Learning/Development Standards In Florida-Including New 4-Yr-Olds | Dev Appropriate Curriculum | | Regency VI |
| 76. Rocks In My Head (<i>Session Repeated, #87</i>) | Dev Appropriate Curriculum | | Regency VII |
| 77. No Worry! Where To Call If You Think Your Child May Need Intervention | Special Needs & Inclusion | | Buccaneer A |
| 78. Can We Teach Children With Challenging Behavior? YES! | Mental Health/Managing Behaviors | | Buccaneer B |
| 79. Professional Development Pathways For Afterschool Practitioners | Management & Leadership | | Buccaneer C |
| 80. There Are No Gender Differences In Play Behaviors Of Immigrant Children | Management & Leadership | | Buccaneer D |
| 81. Managing A Multigenerational Workforce | Management & Leadership | | Esplanade I |
| 82. Talk Isn't Cheap...It's Priceless! | Dev Appropriate Curriculum | | Esplanade II |
| 83. Using Observation-Based Assessment For Children Birth-Kindergarten | Screen/Assess/Evaluations | | Esplanade III |
| 84. Dealing With Difficult Children | Mental Health/Managing Behaviors | | Garrison I-III |
| 10:15 A.M.-11:45 A.M. | CONCURRENT PRESENTATIONS | | |
| 85. Techniques For Working With Difficult People | Family Involvement & Support | | Regency V |
| 86. "How Do I Make Positive Behavior Support Work For ME"? | Mental Health/Managing Behaviors | | Regency VI |
| 87. Rocks In My Head | Dev Appropriate Curriculum | | Regency VII |
| 88. Statewide Possibilities For QRIS | Management & Leadership | | Buccaneer A |
| 89. Play The Domain Way: Totally Terrific Tray Play | Dev Appropriate Curriculum | | Buccaneer B |
| 90. Back To Basics: Meeting Primary Needs Foster Cooperation/Connection | Mental Health/Managing Behaviors | | Buccaneer C |
| 91. Linking Florida's Career Pathway And Registry: What's In It For You! | Management & Leadership | | Buccaneer D |
| 92. Birth-5: Addressing The Needs Of The Youngest Refugees | Cultural Diversity/Multicultural Ed | | Esplanade I |
| 93. Creating A Collaborative System Of Care For Children & Families | Management & Leadership | | Esplanade II |
| 94. Yesology: Sending The Y.E.S. (You're Extra Special) Message | Management & Leadership | | Esplanade III |
| 95. From Desert To Dessert -Discover Power Of Your Outdoor Environment | Child Growth & Development | | Garrison I-III |
| 12:00 NOON -1:30 P.M. | CLOSING GENERAL SESSION | | Regency II |
| | Keynote Speaker: Dr. Pamela C. Phelps | | |

**PROGRAM TRACKS
AT-A-GLANCE**

July 21, 22, 23 Wednesday, Thursday, Friday

| Program Track | Day-Session Number | Time | Room | Program Title |
|--|---------------------------|---------------------------|----------------|--|
| Child Growth and Development | Wednesday-8 | 3:30 p.m.- 5:00 p.m. | Esplanade III | How To Make Those Kindergarten Teachers CRAZY About Our Kids |
| Child Growth and Development | Thursday-12 | 8:30 a.m.- 10:00 a.m. | Regency V | Do You Have Enough: Arranging The Play Environment For Positive Play Experiences And Social Interactions |
| Child Growth and Development | Thursday-31 | 10:15 a.m.- 11:45 a.m. | Garrison I-III | Teaching How Children Learn - Not How You Teach Them |
| Child Growth and Development | Thursday-23 | 10:15 a.m.- 11:45 a.m. | Regency V | More Than Recess: Creating A Successful Outdoor Classroom In A Southern Climate |
| Child Growth and Development | Thursday-37 | 1:30 p.m.- 2:30 p.m. | Buccaneer B | Book Nook |
| Child Growth and Development | Thursday-59 | 2:45 p.m.- 3:45 p.m. | City Center | Movin Up! Movin Out! M-o-o-vin All About! |
| Child Growth and Development | Thursday-72 | 4:00 p.m.- 5:00 p.m. | Ybor | Family Providers Focus On Literacy |
| Child Growth and Development | Friday-73 | 8:30 a.m.- 10:00 a.m. | Regency II | Making The Body-Brain Connection In Teaching And Learning |
| Child Growth and Development | Friday-74 | 8:30 a.m.- 10:00 a.m. | Regency V | More Than Just Talk: Early Communication And Play |
| Child Growth and Development | Friday-80 | 8:30 a.m.- 10:00 a.m. | Buccaneer D | Yes Virginia, There Are No Gender Differences In Play Behaviors Of Young Children Of Immigrant Seasonal Farm Workers From Mexico Living In The United States |
| Child Growth and Development | Friday-95 | 10:15 a.m.- 11:45 a.m. | Garrison I-III | Desert To Dessert - Discover The Power Of Your Outdoor Environment |
| Collaboration | Wednesday-1 | 3:30 p.m.- 5:00 p.m. | Regency V | Strengthening Families - A Challenge In Collaboration |
| Collaboration | Thursday-50 | 2:45 p.m.- 3:45 p.m. | Buccaneer A | A Prime Time Family Experience! |
| Cultural Diversity/ Multicultural Education | Wednesday-7 | 3:30 p.m.- 5:00 p.m. | Esplanade II | Si, Yes, I'm Learning In Two Languages! Dual Language Classroom Strategies |

| Program Track | Day-Session Number | Time | Room | Program Title |
|--|---------------------------|---------------------------|----------------|---|
| Cultural Diversity/ Multicultural Education | Thursday-38 | 1:30 p.m.- 2:30 p.m. | Buccaneer C | Communicating With The English Language Learner In Your Care |
| Cultural Diversity/ Multicultural Education | Friday-92 | 10:15 a.m.- 11:45 a.m. | Esplanade I | Birth-5: Addressing The Needs Of The Youngest Refugees |
| Developmentally Appropriate Curriculum | Wednesday-2 | 3:30 p.m.- 5:00 p.m. | Regency VII | More Than Plastic Bugs And Pinecones! Embedding Science In The Early Childhood Environment |
| Developmentally Appropriate Curriculum | Wednesday-6 | 3:30 p.m.- 5:00 p.m. | Esplanade I | 101 Ways To Use A Word Wall: But Who's Counting? |
| Developmentally Appropriate Curriculum | Wednesday-9 | 3:30 p.m.- 5:00 p.m. | Garrison I-III | Opening The Cover |
| Developmentally Appropriate Curriculum | Wednesday-10 | 3:30 p.m.- 5:00 p.m. | City Center | Serving To Learn, Learning To Serve |
| Developmentally Appropriate Curriculum | Thursday-13 | 8:30 a.m.- 10:00 a.m. | Regency VII | Phonological Fun: Moving Beyond Beginning Sound And Rhyming Words |
| Developmentally Appropriate Curriculum | Thursday-17 | 8:30 a.m.- 10:00 a.m. | Esplanade I | Supporting Educational Benchmarks Through Playful Afterschool Activities |
| Developmentally Appropriate Curriculum | Thursday-20 | 8:30 a.m.- 10:00 a.m. | Garrison I-III | Opening The Cover |
| Developmentally Appropriate Curriculum | Thursday-22 | 8:30 a.m.- 10:00 a.m. | City Center | Making The Most Of Every Minute In The Preschool Classroom |
| Developmentally Appropriate Curriculum | Thursday-28 | 10:15 a.m.- 11:45 a.m. | Esplanade I | Literacy Enhancement For Early Readers: How To Provide Playful Literacy Opportunities In The Preschool Classroom |
| Developmentally Appropriate Curriculum | Thursday-32 | 10:15 a.m.- 11:45 a.m. | City Center | All The Write Moves |
| Developmentally Appropriate Curriculum | Thursday-33 | 1:30 p.m.- 2:30 p.m. | Regency V | Sensory Art Experiences For Infants And Toddlers |
| Developmentally Appropriate Curriculum | Thursday-35 | 1:30 p.m.- 2:30 p.m. | Regency VII | Science: Before And AFTER! |
| Developmentally Appropriate Curriculum | Thursday-39 | 1:30 p.m.- 2:30 p.m. | Buccaneer D | KidVision Voluntary Prekindergarten - VPK Standards Professional Development And Classroom Tools |
| Developmental Appropriate Curriculum | Thursday-43 | 1:30 p.m.- 2:30 p.m. | Garrison I-III | Let's Make Some Music! |
| Developmentally Appropriate Curriculum | Thursday-45 | 1:30 p.m.- 2:30 p.m. | City Center | Chillers, Thrillers And Time Fillers |

| Program Track | Day-Session Number | Time | Room | Program Title |
|--|---------------------------|---------------------------|----------------|--|
| Developmentally Appropriate Curriculum | Thursday-46 | 2:45 p.m.- 3:45 p.m. | Regency II | Character By The Book |
| Developmentally Appropriate Curriculum | Thursday-51 | 2:45 p.m.- 3:45 p.m. | Buccaneer B | Bringing The Story To Life! |
| Developmentally Appropriate Curriculum | Thursday-56 | 2:45 p.m.- 3:45 p.m. | Esplanade III | Inclusion And The Arts Using "Start With The Arts" |
| Developmental Appropriate Curriculum | Thursday-57 | 2:45 p.m.- 3:45 p.m. | Garrison I-III | Let's Make Some Music! |
| Developmentally Appropriate Curriculum | Thursday-60 | 4:00 p.m.- 5:00 p.m. | Regency II | Making Music Matter |
| Developmentally Appropriate Curriculum | Thursday-65 | 4:00 p.m.- 5:00 p.m. | Buccaneer B | Creating Confident Writers |
| Developmentally Appropriate Curriculum | Thursday-71 | 4:00 p.m.- 5:00 p.m. | Garrison I-III | One Book Across The Curriculum |
| Developmentally Appropriate Curriculum | Friday-75 | 8:30 a.m.- 10:00 a.m. | Regency VI | Overview Of The Early Learning And Development Standards In Florida - Including The New Standards For Four-Year-Olds |
| Developmentally Appropriate Curriculum | Friday-76 | 8:30 a.m.- 10:00 a.m. | Regency VII | Rocks In My Head |
| Developmentally Appropriate Curriculum | Friday-82 | 8:30 a.m.- 10:00 a.m. | Esplanade II | Talk Isn't Cheap...It's Priceless! |
| Developmentally Appropriate Curriculum | Friday-87 | 10:15 a.m.- 11:45 a.m. | Regency VII | Rocks In My Head |
| Developmentally Appropriate Curriculum | Friday-89 | 10:15 a.m.- 11:45 a.m. | Buccaneer B | Play The Domain Way: Totally Terrific Tray Play |
| Family Involvement and Support | Thursday-19 | 8:30 a.m.- 10:00 a.m. | Esplanade III | Family Projects: A Home-School Connection! |
| Family Involvement and Support | Thursday-29 | 10:15 a.m.- 11:45 a.m. | Esplanade II | Child Care Resource And Referral (CCR&R) Is The Front Door To Family Services |
| Family Involvement and Support | Thursday-50 | 2:45 p.m.- 3:45 p.m. | Buccaneer A | A Prime Time Family Experience! |
| Family Involvement and Support | Thursday-41 | 1:30 p.m.- 2:30 p.m. | Esplanade II | Bridging The Gap |
| Family Involvement and Support | Thursday-68 | 4:00 p.m.- 5:00 p.m. | Esplanade I | Parents As Teachers - Ahead Of The Curve On Evidence-Based Home Visiting |
| Family Involvement and Support | Friday-85 | 10:15 a.m.- 11:45 a.m. | Regency V | Techniques For Working With Difficult People |
| Health, Safety and Nutrition | Thursday-25 | 10:15 a.m.- 11:45 a.m. | Regency VII | Obesity In Children: Are You The Problem Or The Solution? |

| Program Track | Day-Session Number | Time | Room | Program Title |
|------------------------------|---------------------------|---------------------------|---------------|---|
| Health, Safety and Nutrition | Thursday-40 | 1:30 p.m.- 2:30 p.m. | Esplanade I | KidSafe - Information All Teachers Need To Know |
| Health, Safety and Nutrition | Thursday-55 | 2:45 p.m.- 3:45 p.m. | Esplanade II | The Licensing Counselor's Role In Ensuring Health And Safety In Child Care Settings |
| Management and Leadership | Wednesday-4 | 3:30 p.m.- 5:00 p.m. | Buccaneer C | Creating A Culture Of Safety |
| Management and Leadership | Wednesday-5 | 3:30 p.m.- 5:00 p.m. | Buccaneer D | A New Tool For Measuring Quality In Family Child Care Homes |
| Management and Leadership | Thursday-11 | 8:30 a.m.- 10:00 a.m. | Regency VI | When Budgets Shrink - Where Do We Go And How Do We Get There? |
| Management and Leadership | Thursday-14 | 8:30 a.m.- 10:00 a.m. | Buccaneer B | Managing Time Before It Manages You |
| Management and Leadership | Thursday-15 | 8:30 a.m.- 10:00 a.m. | Buccaneer C | Professional Development And Quality Rating Improvement Systems: Working Together To Improve And Sustain Quality For Young Children |
| Management and Leadership | Thursday-21 | 8:30 a.m.- 10:00 a.m. | Ybor | Florida Early Care And Education Professional Development Initiative: A Progress Report |
| Management and Leadership | Thursday-27 | 10:15 a.m.- 11:45 a.m. | Buccaneer D | Leadership In Action - How To Walk Your Talk |
| Management and Leadership | Thursday-36 | 1:30 p.m.- 2:30 p.m. | Buccaneer A | Educating Our Practitioners Is Just A Click Away! |
| Management and Leadership | Thursday-42 | 1:30 p.m.- 2:30 p.m. | Esplanade III | The Journey To Quality |
| Management and Leadership | Thursday-44 | 1:30 p.m.- 2:30 p.m. | Ybor | T.E.A.C.H. And WAGE\$: Hand-In-Hand Programs Encouraging Professional Development Within Your Child Care Program |
| Management and Leadership | Thursday-53 | 2:45 p.m.- 3:45 p.m. | Buccaneer D | Training Practitioners In Effective Professional Development |
| Management and Leadership | Thursday-54 | 2:45 p.m.- 3:45 p.m. | Esplanade I | Using Self-Assessment To Close The Loop |
| Management and Leadership | Thursday-61 | 4:00 p.m.- 5:00 p.m. | Regency V | Achieving Cohesiveness With Ease |
| Management and Leadership | Thursday-62 | 4:00 p.m.- 5:00 p.m. | Regency VI | Voluntary Prekindergarten Professional Development And Teacher Resources |

| Program Track | Day-Session Number | Time | Room | Program Title |
|--------------------------------------|---------------------------|---------------------------|----------------|---|
| Management and Leadership | Thursday-64 | 4:00 p.m.- 5:00 p.m. | Buccaneer A | A Guide To The Florida Child Care Staff Credential |
| Management and Leadership | Thursday-70 | 4:00 p.m.- 5:00 p.m. | Esplanade III | Islands Of Excellence - Do And Learn Or Sit And Get? Professional Development To Enhance Quality |
| Management and Leadership | Friday-79 | 8:30 a.m.- 10:00 a.m. | Buccaneer C | Professional Development Pathways For Afterschool Practitioners |
| Management and Leadership | Friday-81 | 8:30 a.m.- 10:00 a.m. | Esplanade I | Managing A Multigenerational Workforce |
| Management and Leadership | Friday-88 | 10:15 a.m.- 11:45 a.m. | Buccaneer A | Quality Rating Improvement Systems (QRIS) - The Vision...The Journey To A Statewide System |
| Mental Health/ Managing Behaviors | Thursday-18 | 8:30 a.m.- 10:00 a.m. | Esplanade II | Identifying And Reducing Inappropriate Behavior |
| Mental Health/ Managing Behaviors | Thursday-24 | 10:15 a.m.- 11:45 a.m. | Regency VI | You Should KNOW Better! Helping Children Accept Responsibility For Their Choices Report |
| Management and Leadership | Friday-91 | 10:15 a.m.- 11:45 a.m. | Buccaneer D | Linking Florida's Career Pathway And Registry: What's In It For You! |
| Management and Leadership | Friday-93 | 10:15 a.m.- 11:45 a.m. | Esplanade II | Moving Florida Forward: Creating A Collaborative System Of Care For Children And Families |
| Management and Leadership | Friday-94 | 10:15 a.m.- 11:45 a.m. | Esplanade III | Yesology: Sending The Y.E.S. (You're Extra Special) Message |
| Mental Health/ Managing Behaviors | Thursday-47 | 2:45 p.m.- 3:45 p.m. | Regency V | It's All About Teaching - Strategies To Reduce Challenging Behaviors And Improve The Quality Of Your Early Childhood Program! |
| Mental Health/ Managing Behaviors | Thursday-63 | 4:00 p.m.- 5:00 p.m. | Regency VII | If I Can't Picture It, I Can't Understand It: The Effective Use Of Visual Supports |
| Mental Health/ Managing Behaviors | Friday-78 | 8:30 a.m.- 10:00 a.m. | Buccaneer B | Can We Teach Children With Challenging Behavior? YES! |
| Mental Health/ Managing Behaviors | Friday-84 | 8:30 a.m.- 10:00 a.m. | Garrison I-III | Dealing With Difficult Children |
| Mental Health/ Managing Behaviors | Friday-86 | 10:15 a.m.- 11:45 a.m. | Regency VI | "How Do I Make Positive Behavior Support Work For ME"? |

| Program Track | Day-Session Number | Time | Room | Program Title |
|--|---------------------------|---------------------------|----------------|--|
| Mental Health/ Managing Behaviors | Friday-90 | 10:15 a.m.- 11:45 a.m. | Buccaneer C | Back To Basics: Meeting Primary Needs To Foster Cooperation And Connection With ALL Children |
| Public Policy and Advocacy | Wednesday-3 | 3:30 p.m.- 5:00 p.m. | Buccaneer B | The Federal Landscape: Assessing The Opportunities For Early Care And Education |
| Public Policy and Advocacy | Thursday-26 | 10:15 a.m.- 11:45 a.m. | Buccaneer B | 2011 State And Federal Legislative Review |
| Public Policy and Advocacy | Thursday-52 | 2:45 p.m.- 3:45 p.m. | Buccaneer C | Early Learning Information System (ELIS) Overview And Focus Group |
| School-Age Child Care | Thursday-17 | 8:30 a.m.- 10:00 a.m. | Esplanade I | Supporting Educational Benchmarks Through Playful Afterschool Activities |
| School-Age Child Care | Friday-79 | 8:30 a.m.- 10:00 a.m. | Buccaneer C | Professional Development Pathways For Afterschool Practitioners |
| Screenings/ Assessments/ Evaluations | Thursday-34 | 1:30 p.m.- 2:30 p.m. | Regency VI | Voluntary Prekindergarten (VPK) Assessment Overview |
| Screenings/ Assessments/ Evaluations | Thursday-48 | 2:45 p.m.- 3:45 p.m. | Regency VI | Florida Kindergarten Readiness Screener (FLKRS) And The Voluntary Prekindergarten (VPK) Readiness Rate |
| Screenings/ Assessments/ Evaluations | Thursday-66 | 4:00 p.m.- 5:00 p.m. | Buccaneer C | Early Learning Partners Initiative-What's In It for Children? |
| Screenings/ Assessments/ Evaluations | Friday-83 | 8:30 a.m.- 10:00 a.m. | Esplanade III | Using Observation-Based Assessment For Children Birth Through Kindergarten: The Palette Of Early Childhood Development And Experiences |
| Special Needs and Inclusion | Thursday-16 | 8:30 a.m.- 10:00 a.m. | Buccaneer D | Overview of Epilepsy |
| Special Needs and Inclusion | Thursday-30 | 10:15 a.m.- 11:45 a.m. | Esplanade III | Early Signs Of Autism |
| Special Needs and Inclusion | Thursday-43 | 1:30 p.m.- 2:30 p.m. | Garrison I-III | Let's Make Some Music! |
| Special Needs and Inclusion | Thursday-49 | 2:45 p.m.- 3:45 p.m. | Regency VII | Promoting Physical Activity Among Young Children With Autism Spectrum Disorders |

| Program Track | Day-Session Number | Time | Room | Program Title |
|-----------------------------|---------------------------|--------------------------|----------------|---|
| Special Needs and Inclusion | Thursday-56 | 2:45 p.m.- 3:45 p.m. | Esplanade III | Inclusion And The Arts Using "Start With The Arts" |
| Special Needs and Inclusion | Thursday-57 | 2:45 p.m.- 3:45 p.m. | Garrison I-III | Let's Make Some Music! |
| Special Needs and Inclusion | Thursday-58 | 2:45 p.m.- 3:45 p.m. | Ybor | What's A TATS? |
| Special Needs and Inclusion | Thursday-67 | 4:00 p.m.- 5:00 p.m. | Buccaneer D | Early Recognition, Early Success: Overview Of Early Steps |
| Special Needs and Inclusion | Thursday-69 | 4:00 p.m.- 5:00 p.m. | Esplanade II | Identifying And Nurturing Potential In Young Children With Dual Languages And Dual Exceptionalities |
| Special Needs and Inclusion | Friday-74 | 8:30 a.m.- 10:00 a.m. | Regency V | More Than Just Talk: Early Communication And Play |
| Special Needs and Inclusion | Friday-77 | 8:30 a.m.- 10:00 a.m. | Buccaneer A | No Worry! Where To Call If You Think Your Child May Need Intervention |

Florida Early Learning and Developmental Standards

To help you in selecting workshops, we have included the Domains for the Florida Early Learning and Developmental Standards:

Physical Development
Approaches to Learning
Social and Emotional Development
Language, Communication and Emergent Literacy
Cognitive Development & General Knowledge

Core Competencies for Practitioners

To help you in selecting workshops, we have included the Core Knowledge Areas for the Core Competencies for Practitioners:

Health, Safety, and Nutrition
Child Development and Learning
Building Family and Community Relationships
Teaching and Learning Environments and Interactions
Curriculum
Observing, Documenting, Screening, and Assessing to Support Young Children and Their Families
Professionalism

Nancy D. Thomas Collaboration Award

Nancy Duran Thomas was a lifelong educator, a preschool teacher, a county curriculum consultant, coordinator of exceptional student education, and Director of the Office of Early Intervention, Florida Department of Education. She was the driving force behind many collaborative efforts to ensure high quality programs for all young children and their families. This conference was Nancy's vision and she made it a reality in 1987. Although she passed away in 2000, her memory lives on in this conference. In 2000, the One Goal Summer Conference Planning Committee wanted to recognize Nancy for her many collaborative achievements, so they established the Nancy D. Thomas Collaboration Award. The award is presented to individuals for their statewide efforts to foster and maintain collaboration among programs and services for all children and their families in the State of Florida. This is the 25th Anniversary of the One Goal Summer Conference and we want to recognize those individuals who have received the Nancy D. Thomas Collaboration Award.



2000
Nancy D. Thomas



2001
Marilyn "Mickey" Segal



2002
Bebe Fearnside



2003
Williams S. Fillmore, Jr.



2004
Ann K. Levy



2005
Carole Fox Abbott



2006
Barbara Mainster



2007
Mary E. Bryant



2008
Wil Blechman



2009
Landis Stetler

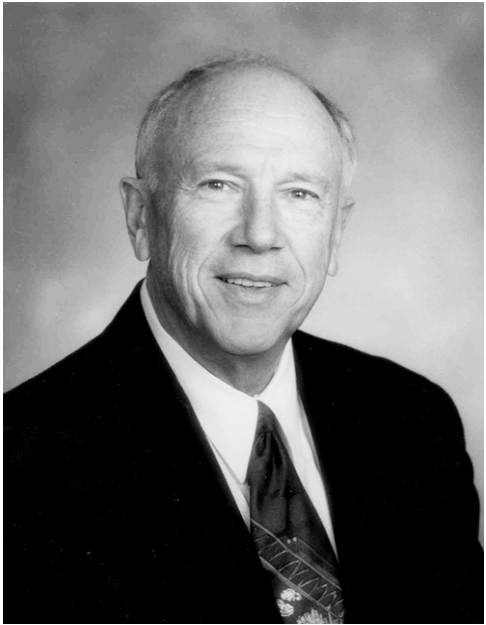

2010
Samuel P. Bell, III

SPOTLIGHTING THE EXHIBITS!

WEDNESDAY, JULY 20, 2011

Educational Programs & Services Exhibits

Regency I

Exhibits will spotlight various educational programs and services available. Come in anytime and browse on Wednesday, July 20, 2011, from 10:00 a.m. - 5:00 p.m.

THURSDAY, JULY 21, 2011 and FRIDAY, JULY 22, 2011

Commercial Exhibits

Regency I

Exhibits will be open from 8:00 a.m. - 5:00 p.m. on Thursday, July 21, 2011 and 8:00 a.m. - 11:45 a.m. on Friday, July 22, 2011. The exhibitors provide funds for our coffee breaks and door prizes for the Closing General Session on Friday, July 22, 2011. The sales reps purchase the items they have on display, so please support their efforts by visiting the exhibitor booths.

FIRST TIMERS' ORIENTATION SESSION WEDNESDAY, JULY 20, 2011

12:00 NOON-12:45 P.M. One Goal Summer Conference: 101

Regency V

If this is your first time attending the conference....then this session is for you! We will share information and tips to help you get the most out of the conference. We will not only provide an overview of the conference and conference events, but answer many important questions, such as: Where are the Esplanade meeting rooms? Where do the locals go for lunch? Where did the men's restrooms go? Who are the people in the pink vests? Where do I go, if I need assistance? Come and join us....we want your conference experience to be enjoyable.

Pamela C. Phelps, Ph.D., Consultant for Creative Center for Childhood Research & Training, Inc.

Director of The Creative Pre-School
2746 West Tharpe Street
Tallahassee, FL 32303

Phone: 850-386-1450
FAX: 850-422-1283
E-Mail: cccrt@comcast.net

Carole West, Program Specialist

Florida Department of Education
325 West Gaines Street, Suite 601
Tallahassee, FL 32399-0400

Phone: 850-245-0478
FAX: 850-245-0955
E-Mail: Carole.West@fldoe.org

WEDNESDAY, JULY 20, 2011

1:00 P.M. - 3:15 P.M.

OPENING GENERAL SESSION

Regency II

Presiding:

Theodore G. Granger
Chair, One Goal Summer Conference
Tallahassee, Florida

Keynote Speaker:

Naomi Haines Griffith
M.A., M.S.W., Author, Motivational Speaker
Red Clay and Vinegar, Inc
Nashville, Tennessee



Naomi Haines Griffith is a national speaker and consultant on child welfare issues, speaking at conferences throughout the United States and Canada. A well-known storyteller and family systems specialist, she uses humor and her own experiences to challenge and inspire audiences in business, education, juvenile justice, mental health, child abuse prevention, and family violence systems. Griffith is a true Southerner, having grown up in Alabama and Mississippi. She holds a BS from the University of North Alabama, an M.A. from George Peabody College of Vanderbilt University, and a Masters in Social Work from the University of Alabama. She worked in the North Carolina and Alabama child welfare systems and became Executive Director of PACT, a pioneer child abuse prevention agency she helped to found. She has also served on the State Board of the Alabama Department of Human Resources.

Griffith is a former board member for the Alabama Children's Trust Fund and has worked as a consultant to and trainer for Prevent Child Abuse America. She is the President of Red Clay & Vinegar LLP. It has been noted that: "Naomi weaves her common sense pragmatism and 30 years experience working with children and families into inspirational and heart-warming stories that motivate her audiences both personally and professionally." She is the author of *Red Clay and Vinegar: Looking at Family through the eyes of a Southern Child* and the co-author of *The Unkindest Cut - The Emotional Maltreatment of Children*.

Phone: 615-650-9440, E-Mail: redclaynhg@aol.com

CONCURRENT PRESENTATIONS

WEDNESDAY, JULY 20, 2011

3:30 P.M. - 5:00 P.M.

1. Strengthening Families - A Challenge In Collaboration Regency V

This presentation focuses on what must be done to strengthen families, who can do it, and how to get it done. This includes a discussion on what is meant by "prevention" and a specific, practical, multi-disciplinary list of prevention strategies that can be used by existing systems, e.g. education, health, and judicial as well as government and community groups.

Program Track: Collaboration

Target Audience: Administrators, Directors, Family Support, Teachers: New and Experienced

Core Competencies: Building Family and Community Relationships

Presenter(s):

Naomi Haines Griffith, *President*

Red Clay and Vinegar
Post Office Box 68275
Nashville, TN 37206

Phone: 888-682-9440
FAX: 615-650-9385
E-Mail: redclaynhg@aol.com

2. More Than Plastic Bugs And Pinecones! Embedding Science In The Early Childhood Environment Regency VII

Experience the world of nature and science from the eyes of a child. This session will guide teachers in understanding the correlation between safety, standards, developmentally appropriate activities, and the interests of the children. Participants will be guided through planning and implementation of strategies in the classroom to connect all learning domains of nature and science. Join us in exploring materials, thinking creatively, and bringing science centers alive through engaging activities.

Program Track: Developmentally Appropriate Curriculum

Target Audience: Teachers: New and Experienced

Domain (Standard): Cognitive Development and General Knowledge

Core Competencies: Teaching and Learning Environments and Interactions Curriculum

WEDNESDAY, JULY 20, 2011

3:30 P.M. - 5:00 P.M.

Presenter(s):

Lisa Toscano, *Manager Quality Assurance*
The Early Learning Coalition of Florida's Heartland
324 North 6th Avenue
Wauchula, FL 33873

Phone: 863-558-6010
E-Mail: ltoscano@elcfh.org

Denise Franze, *Early Learning Specialist*
The Early Learning Coalition of Florida's Heartland
6432 US Hwy 27 South
Sebring, FL 33876

Phone: 863-314-9213, ext. 110
E-Mail: dfranze@elcfh.org

**3. The Federal Landscape: Assessing The Opportunities
For Early Care And Education**

Buccaneer B

This presentation will provide an update from the federal level on the opportunities and challenges facing the field of early care and education. Significant legislation will be discussed, as well as ways that the field can have an impact on the conversations both at home and in Congress. Understanding the windows of opportunity, as well as the budget process, is critical in moving the agenda for young children and their families forward in our country.

Program Track: Public Policy and Advocacy

Target Audience: Administrators, Direct Service Providers, Directors,
Teachers: New and Experienced, Training and Technical
Staff

Core Competencies: Professionalism

Presenter(s):

Helen Blank, *Director, Leadership and Public Policy*
National Women's Law Center
11 Dupont Circle NW, Suite 800
Washington, DC 20036

Phone: 202-588-5180
E-Mail: hblank@nwlc.org



Helen Blank leads the National Women's Law Center's work on early education, as well as its leadership activities including PLAN, the Progressive Leadership and Advocacy Network, a program for emerging leaders on low-income woman's issues. Previously, Blank served 24 years as the director of the Child Care and Development Division at the Children's Defense Fund. While at the Children's Defense Fund, she spearheaded a variety of efforts for improved early learning legislation. Blank also created and ran an emerging leaders program for rising leaders in early childhood education. She is a member of the T.E.A.C.H.® Early Childhood Advisory Committee, the board of Teach for America's Prekindergarten Initiative, the Child Care Food Program Sponsors' Forum, and the Advisory Board for LISC, the Local Initiative Support Corporation.

WEDNESDAY, JULY 20, 2011

3:30 P.M. - 5:00 P.M.

4. Creating A Culture Of Safety

Buccaneer C

Mickey is the child that climbs up the slide instead of using the ladder, pulls Susie's hair, pokes your teacher in the eye, and is allergic to peanuts. How many Mickeys come to your school? Learn how to manage the risk Mickey presents. Agnes is the teacher that cares so much about the children she doesn't see how her actions can either keep her safe or lead to her injury. This session will focus on creating a culture of safety. This safety-oriented focus will help protect your school from liability and workers' compensation issues that could have a dramatic effect on your school and possibly cause your school to close.

Program Track: Management and Leadership

Target Audience: Administrators

Domain (Standard): Physical Development

Core Competencies: Teaching and Learning Environments and Interactions

Presenter(s):

Beth A. Block, *President*

Block Insurance

Post Office Box 623188

Oviedo, FL 32762

Phone: 407-365-4775

FAX: 407-365-1862

E-Mail: beth@blockinsurance.net

**5. A New Tool For Measuring Quality In Family
Child Care Homes**

Buccaneer D

Prior to the implementation of this program, the Early Learning Coalition of Orange County only completed Health and Safety inspections and offered the Let's Get Licensed Program with registered providers. The Board directed staff to develop a plan to implement quality initiatives for this group of providers. After looking at several tools, Connie Selmi, our Family Child Care Home Specialist developed a tool. After many reviews and revisions this tool was finalized and approved. The results have been excellent. Providers are requesting Technical Assistance and using the tool for program improvement. A side effect is that our Let's Get Licensed Program has been revitalized.

Program Track: Management and Leadership

Target Audience: Administrators, Direct Service Providers, Training and Technical Staff

Core Competencies: Child Development and Learning
Teaching and Learning Environments and Interactions

WEDNESDAY, JULY 20, 2011

3:30 P.M. - 5:00 P.M.

Presenter(s):

Connie Selmi, *Family Child Care Specialist*
Early Learning Coalition of Orange County
1940 Traylor Boulevard
Orlando, FL 32805

Phone: 407-922-8197
FAX: 407-749-0282
E-Mail: cselmi@elcoc.org

Lois Smith, *Director of Provider Services*
Early Learning Coalition of Orange County
1940 Traylor Boulevard
Orlando, FL 32805

Phone: 407-259-2472
FAX: 407-749-0282
E-Mail: lsmith@elcoc.org

6. 101 Ways To Use A Word Wall: But Who's Counting?

Esplanade I

Participants will be engaged in learning and proposing new and exciting ways to utilize a word wall in the early childhood classroom. This presentation will include ideas for classroom management, early childhood education, early literacy, ESL/ELL, Head Start Performance Standards, instructional practices, pre-reading skills development, and correlations with state prekindergarten standards.

Program Track: Developmentally Appropriate Curriculum

Target Audience: Teachers: New and Experienced

Domain (Standard): Language, Communication and Emergent Literacy

Core Competencies: Teaching and Learning Environments and Interactions
Curriculum

Presenter(s):

Bambi Fischer, *Head Start Teacher*
Head Start/Lee County Schools
6640 Hartland Street
Ft. Myers, FL 33966

Phone: 239-691-3071
E-Mail: Bambilf@leeschools.net

Yolanda Figueroa, *Head Start Teacher*
Head Start/Lee County Schools
328 SW 19th Terrace
Cape Coral, FL 33991

Phone: 239-939-2242
E-Mail: YolandaF@leeschools.net

WEDNESDAY, JULY 20, 2011

3:30 P.M. - 5:00 P.M.

7. Si, Yes, I'm Learning In Two Languages! Dual Language Classroom Strategies

Esplanade II

A significant number of children in the U.S. are exposed to more than one language from birth. Dual language learning has many benefits for children and families, including stronger connections to their families and culture. Dual language is also a barrier for young children unable to master two languages, often leaving them with no language, poor social/emotional experiences and concept of self. This presentation will provide classroom strategies and suggestions to engage families, including how to embed bilingual learning opportunities. Excellent handouts and resources will be provided. Time will be available for questions and answers.

Program Track: Cultural Diversity/Multicultural Education

Target Audience: Directors, Family Support, Teachers: New and Experienced, Training and Technical Staff

Domain (Standard): Language, Communication and Emergent Literacy

Core Competencies: Child Development and Learning
Teaching and Learning Environments and Interactions

Presenter(s):

Sandra Ampudia, *STEPS Inclusion Specialist*
Early Learning Coalition of Miami - Dade/Monroe
2555 Ponce de Leon Boulevard, 5th Floor
Coral Gables, FL 33134

Phone: 786-942-2546
FAX: 305-447-1608
E-Mail: sampudia@elcmdm.org

Bethany Sands, *Inclusion and Assessment Program Director*
Early Learning Coalition of Miami - Dade/Monroe
2555 Ponce de Leon Boulevard, 5th Floor
Coral Gables, FL 33134

Phone: 305-646-7248
FAX: 305-447-1608
E-Mail: bsands@elcmdm.org

8. How To Make Those Kindergarten Teachers CRAZY About Our Kids

Esplanade III

We will discuss the theory of Uri Brofenbrenner regarding resiliency in children and share practical ways to ensure our children are ready to face the challenges ahead of them. The social, emotional, and cognitive needs of children today will be stressed. Participants will leave with a plethora of ideas and practical ways to ensure our students are prepared for the rigors of today's educational demands.

Program Track: Child Growth and Development

WEDNESDAY, JULY 20, 2011

3:30 P.M. - 5:00 P.M.

Target Audience: Teachers: New and Experienced

Core Competencies: Observing, Documenting, Screening, and Assessing to Support Young Children and Their Families

Presenter(s):

Florie Babcock, Ph.D., Head Start Resource Teacher

Polk County Schools Head Start

1399 CR 753

Webster, FL 33597

Phone: 863-398-7620

FAX: 863-648-3050

E-Mail: florence.babcock@polk-fl.net

9. Opening The Cover

Garrison I-III

(Session Repeated, #20)

This lively, interactive session will use music, power-point and inexpensive props to show early childhood educators how to provide hands-on activities in their classrooms. Participants will see how to use current classroom materials to create developmentally appropriate activities that are related to children's literature and emergent reading skills.

Program Track: Developmentally Appropriate Curriculum

Target Audience: Teachers: New and Experienced

Domain (Standard): Language, Communication and Emergent Literacy

Core Competencies: Teaching and Learning Environments and Interactions Curriculum

Presenter(s):

Linda McConkey, Resource Coordinator

Early Learning Coalition of Indian River, Martin, and

Okeechobee Counties

180 Coral Lane

Vero Beach, FL 32960

Phone: 772-532-1314

FAX: 772-567-7420

E-Mail: verolindarae@yahoo.com

Sheila Ettehadieh, Resource Coordinator/Inclusion Coordinator

Early Learning Coalition of Indian River, Martin, and

Okeechobee Counties

10 SE Central Parkway, Suite 400

Stuart, FL 34994

Phone: 772-223-3855

FAX: 772-567-7420

E-Mail: settehadieh@elcirimo.org

WEDNESDAY, JULY 20, 2011

3:30 P.M. - 5:00 P.M.

10. Serving To Learn, Learning To Serve

City Center
(located first floor, hotel registration lobby)

Empower young children to use what they learn in the classroom to make a difference in their community and the world around them! The practice of service-learning challenges children to grow as learners and citizens. This informative session provides ideas for preschool service projects.

Program Track: Developmentally Appropriate Curriculum

Target Audience: Directors, Teachers: New and Experienced, Training and Technical Staff

Domain (Standard): Cognitive Development and General Knowledge

Core Competencies: Professionalism

Presenter(s):

Suzanne Adinolfi, *Education/Inclusion Specialist*
Early Learning Coalition of Northwest Florida
9215 Faith Lane
Panama City Beach, FL 32407

Phone: 773-425-2564
FAX: 850-747-5450
E-Mail: sdadinolfi@yahoo.com

5:00 P.M. - 6:00 P.M.

**“REDISCOVERING YOUR CHILD”
25th ANNIVERSARY RECEPTION**

Regency II

Come and join us for our 25th Anniversary Celebration. Champagne punch and snacks provided compliments of the Hyatt Regency. Chocolate fountain courtesy of Kaplan Corporation. Cash bar available for beer and wine. Entertainment provided by the Angel Band. This is an excellent opportunity to network with speakers and colleagues.

6:00 P.M. - 10:00 P.M. FREE SHUTTLE TO INTERNATIONAL PLAZA MALL

International Plaza is the most distinctive shopping and dining destination on Florida’s west coast. The Plaza and Bay Street at the Plaza...an open-air village of fine restaurants and boutiques...offer over 200 specialty shops and thirteen restaurants. The shuttle bus stop is located directly in front of the hotel registration lobby.

CONCURRENT PRESENTATIONS

THURSDAY, JULY 21, 2011

8:30 A.M. - 10:00 A.M.

11. When Budgets Shrink - Where Do We Go And How Do We Get There?

Regency VI

Budgets are being slashed at all levels of government, but now is not the time to retreat. How do we move forward, where are we going, and how do we get there? What opportunities exist during the next two years, and if there are opportunities, what is our responsibility to lead? We invite you to join a frank discussion on how to make the most during times of fiscal stress and change.

Program Track: Management and Leadership

Target Audience: Administrators, Direct Service Providers, Directors,

Core Competencies: Professionalism

Presenter(s):

Linda K. Smith, *Executive Director*

National Association of Child Care Resource and Referral Age
3101 Wilson Boulevard, Suite 350
Arlington, VA 22201

Phone: 703-341-4100
E-Mail: Linda.Smith@naccrra



Linda Smith is the Executive Director of the National Association of Child Care Resource and Referral Agencies (NACCRRRA). NACCRRRA represents over 700 community-based child care resource and referral agencies located in all states and nearly every community. Smith is an expert in the field of early care and education systems and program development. During her 25 years experience at the Department of Defense, she served as the Director of Family Policy, where she was responsible for policy and oversight of comprehensive family service programs affecting 2.1 million family members of military personnel. Smith led implementation of the landmark Military Child Care Act of 1989, vastly transforming the program into one singled out by President Clinton and the United States Congress as a “model for the nation.” Prior to joining NACCRRRA. She served as a Legislative Fellow and professional staffer on the United States Senate Health, Education, Labor and Pensions Committee under the Chairmanship of Senator Edward M. Kennedy.

THURSDAY, JULY 21, 2011

8:30 A.M. - 10:00 A.M.

**12. Do You Have Enough? Arranging The Play Environment
For Positive Play Experiences And Social Interactions**

Regency V

Many discipline situations with young children are a result of inadequate and unorganized materials. This presentation will focus on kinds of play children engage in and how to access children's social interactions. Attendees will be provided with information substantiated by research and theory that will help them choose and organize appropriate amounts of play materials for the toddlers and preschool children in their care.

Program Track: Child Growth and Development

Target Audience: Administrators, Directors, Teachers: New and Experienced

Domain (Standard): Social and Emotional Development

Core Competencies: Child Development and Learning
Teaching and Learning Environments and Interactions

Presenter(s):

Pamela C. Phelps, Ph.D., Consultant for Creative Center for Childhood Research & Training, Inc.

Director of The Creative Pre-School
2746 West Tharpe Street
Tallahassee, FL 32303

Phone: 850-422-1080
FAX: 850-422-1283
E-Mail: ccprt@comcast.net

**13. Phonological Fun: Moving Beyond Beginning Sound
And Rhyming Words**

Regency VII

The path to phonological awareness, a strong predictor of later reading and writing skills, begins with an understanding of words, then beginning sounds and rhymes, followed by syllables, onsets and rimes, and finally individual sounds within words. This interactive session will engage participants in activities all along the phonological awareness developmental continuum to strengthen teachers' understanding of how young learners acquire these skills. Leave this session with a wealth of activities to use with your students, along with a plan for assuring that every child has fun while mastering the skills along the phonological awareness continuum.

Program Track: Developmentally Appropriate Curriculum

Target Audience: Directors, Teachers: New and Experienced

Domain (Standard): Language, Communication and Emergent Literacy

THURSDAY, JULY 21, 2011

8:30 A.M. - 10:00 A.M.

Core Competencies: Teaching and Learning Environments and Interactions
Curriculum

Presenter(s):

Bronwyn McLemore, Ph.D., Curriculum Specialist

Florida Institute of Education at the University of North Florida Phone: 904-620-4440
12000 Alumni Drive FAX: 904-620-2454
Jacksonville, FL 32224 E-Mail: Bmclemor@unf.edu

14. Managing Time Before It Manages You Buccaneer B

Learning to manage time can be done without reinventing your life. This presentation offers easy to apply methods that will allow participants to regain control of time and to experience positive results immediately. This presentation encourages participants to use these steps in both their personal and professional lives. Since we are creatures of habit, if we mismanage time in one area of our life, there is a good chance we will mismanage it elsewhere. Participants will be asked to make a commitment to adopt at least one method and to implement it immediately. The instructor of this presentation then follows up with the progress and is available to assist and encourage them in their process.

Program Track: Management and Leadership

Target Audience: Administrators, Directors, Training and Technical Staff

Core Competencies: Professionalism

Presenter(s):

Cynthia Krosky, CSP, LCSW

Achieving Corporate Excellence, Inc.
Post Office Box 651119 Phone: 772-461-8313
Vero Beach, FL 32965-1119 E-Mail: achieve@achievingcorporateexcellence.com

**15. Professional Development And Quality Rating Improvement
Systems: Working Together To Improve And Sustain Quality
For Young Children** Buccaneer C

Florida has launched Steps to Success, the state's professional development system. Additionally, some counties have implemented voluntary quality rating improvement systems to create and improve quality caring environments for young children. How do these two systems fit together? This session will explore the symbiotic relationship between these systems based on the work in Miami-Dade County and present findings of the Quality Counts Early Childhood Workforce Study.

THURSDAY, JULY 21, 2011

8:30 A.M. - 10:00 A.M.

Program Track: Management and Leadership

Target Audience: Administrators, Direct Service Providers, Directors, Training and Technical Staff

Core Competencies: Professionalism

Presenter(s):

Phyllis Kalifeh, *President/CEO*

Children's Forum, Inc.
2807 Remington Green Circle
Tallahassee, FL 32308

Phone: 850-681-7002
FAX: 850-681-9816

E-Mail: pkalifeh@thechildrensforum.com

Jesse Leinfelder, *Ph.D., Quality Counts Administrator*

The Children's Trust
3150 SW 3rd Avenue
Miami, FL 33129

Phone: 954-914-9738

E-Mail: jesse.leinfelder@thechildrenstrust.org

Melissa Clements, *Ph.D., Director of Research*

Children's Forum, Inc.
2807 Remington Green Circle
Tallahassee, FL 32308

Phone: 850-681-7002
FAX: 850-681-9816

E-Mail: mclements@thechildrensforum.com

16. Overview of Epilepsy

Buccaneer D

Epilepsy is a neurological disorder, which briefly interrupts the normal function of the brain. These brief interruptions or seizures are produced by an abnormal electrical discharge in the brain which can produce changes in movement, behavior, sensation, or consciousness. This interactive presentation will provide an overview of epilepsy. Discussion will include causes, diagnosis, statistics and demographics, treatment options, and psycho-issues. This presentation will also provide information about recognition and first aid. A question and answer time will be provided. Resource materials will be distributed.

Program Track: Special Needs and Inclusion

Target Audience: Direct Service Providers, Directors, Teachers: New and Experienced

Domain (Standard): Physical Development

Core Competencies: Health, Safety and Nutrition
Child Development and Learning

THURSDAY, JULY 21, 2011

8:30 A.M. - 10:00 A.M.

Presenter(s):

Lou Garcia, *Prevention Coordinator*

Epilepsy Services of West Central Florida, Inc.
4618 North America Avenue
Tampa, FL 33603

Phone: 813-870-3414

FAX: 813-870-1321

E-Mail: lgarcia@epilepsyservices.com

**17. Supporting Educational Benchmarks Through Playful
Afterschool Activities**

Esplanade I

Join us in creating an educational, motivational K-5 summer camp or afterschool curriculum as we transform the Sunshine State Standards into playful activities that reinforce math, science, physical education, and language skills. Basic afterschool lesson planning concepts will also be featured along with free resources for activity planning. Participants will leave this session armed with dozens of fun, yet educational, activities to take back to their program to implement immediately!

Program Track: Developmentally Appropriate Curriculum
School-Age Child Care

Target Audience: Directors, Teachers: New and Experienced

Domain (Standard): Sunshine State Standards

Core Competencies: Teaching and Learning Environments and Interactions
Curriculum

Presenter(s):

Jennifer Faber, *State School-Age Services Coordinator*

Agency for Workforce Innovation, Office of Early Learning
6973 Kimberly Terrace
Ft. Myers, FL 33919

Phone: 239-433-6597

FAX: 239-433-6603

E-Mail: Jennifer.Faber@flaawi.com

18. Identifying And Reducing Inappropriate Behavior

Esplanade II

Teachers, parents, and classmates tend to feel that some children "misbehave all the time." What this "misbehavior" looks like will be discussed. The presenter will share methods for objectively observing a child's behavior in the classroom and other settings to help teachers determine when and where a child tends to exhibit inappropriate behavior. Why the child may be exhibiting these behaviors will also be discussed. The presenter and participants will then share strategies for reducing the inappropriate behavior. When to refer a child for evaluation will also be discussed.

THURSDAY, JULY 21, 2011

8:30 A.M. - 10:00 A.M.

Program Track: Mental Health/Managing Behaviors
Target Audience: Administrators, Directors, Teachers: New and Experienced
Domain (Standard): Social and Emotional Development
Core Competencies: Child Development and Learning
Teaching and Learning Environments and Interactions

Presenter(s):

Dana Fredebaugh, Ph.D., Program Professor
Nova Southeastern University
1750 NE 167 Street
North Miami Beach, FL 33162

Phone: 954-262-8632
FAX: 954-262-3826
E-Mail: danaf@nova.edu

19. Family Projects: A Home-School Connection!

Esplanade III

"Where's our homework?" This presentation will focus on family projects as an exciting way to extend the learning from preschool into the home. We will trace the family projects done throughout a school year and discuss how they changed over the year, from low-risk projects that invited families to explore open-ended art with their children to more in-depth projects that challenged the families to explore literacy. Most importantly, we will learn about a project that celebrates the cultural diversity of each child and each family. As teachers, we knew the children would enjoy our projects and we expected the families to learn more about how their children learn at school. Along the way we were surprised to discover how much we learned from the families!

Program Track: Family Involvement and Support
Target Audience: Teachers: New and Experienced
Core Competencies: Building Family and Community Relationships
Teaching and Learning Environments and Interactions

Presenter(s):

Cindy McConnell, Director / Lead VPK Teacher
First Discoveries Child Development Center
4003 South Manhattan Avenue
Tampa, FL 33611

Phone: 813-831-8085
E-Mail: info@achildsfirstdiscoveries.com

THURSDAY, JULY 21, 2011

8:30 A.M. - 10:00 A.M.

20. Opening The Cover
(Repeat Session)

Garrison I-III

This lively, interactive session will use music, power-point, and inexpensive props to show early childhood educators how to provide hands-on activities in their classrooms. Participants will see how to use current classroom materials to create developmentally appropriate activities that are related to children's literature and emergent reading skills.

Program Track: Developmentally Appropriate Curriculum

Target Audience: Teachers: New and Experienced

Domain (Standard): Language, Communication and Emergent Literacy

Core Competencies: Teaching and Learning Environments and Interactions
Curriculum

Presenter(s):

Linda McConkey, *Resource Coordinator*

Early Learning Coalition of Indian River, Martin, and
Okeechobee Counties
180 Coral Lane
Vero Beach, FL 32960

Phone: 772-532-1314

FAX: 772-567-7420

E-Mail: verolindarae@yahoo.com

Sheila Ettehadieh, *Resource Coordinator/Inclusion Coordinator*

Early Learning Coalition of Indian River, Martin, and
Okeechobee Counties
10 SE Central Parkway, Suite 400
Stuart, FL 34994

Phone: 772-223-3855

FAX: 772-567-7420

E-Mail: settehadieh@elcirmo.org

**21. Florida Early Care And Education Professional
Development Initiative: A Progress Report**

Ybor

There have been remarkable advances this year in the development and implementation of Florida's Early Care and Education Professional Development System, now referred to as Steps to Success! This session will provide an overview of all the system pieces and coordination efforts. Information on core competencies, the career pathway, quality assurance mechanisms, and the registry will be shared and discussed.

Program Track: Management and Leadership

Target Audience: Administrators, Direct Service Providers, Directors,
Teachers: New and Experienced, Training and Technical
Staff

THURSDAY, JULY 21, 2011

8:30 A.M. - 10:00 A.M.

Core Competencies: Professionalism

Presenter(s):

Alisa Ghazvini, Ph.D.

Early Childhood Consultant
1462 Mitchell Avenue.
Tallahassee, FL 32303

Phone: 850-545-7716
FAX: 850-893-0683
E-Mail: aghazvini@hotmail.com

22. Making The Most Of Every Minute In The Preschool Classroom City Center
(located first floor, hotel registration lobby)

Learn new strategies for integrating fun and developmentally appropriate activities in the classroom. Teachers will have the opportunity to examine their own routines and transitions in order to find learning opportunities that are typically lost during each busy preschool day. Participants will engage in lively discussions and collaborate with each other to take away ideas that they can put into action immediately. These strategies can help children develop self-regulation by encouraging them to build on their own interests and skills in appropriate ways during the most difficult parts of the preschool day.

Program Track: Developmentally Appropriate Curriculum

Target Audience: Administrators, Teachers: New and Experienced

Domain (Standard): Social and Emotional Development

Core Competencies: Teaching and Learning Environments and Interactions
Curriculum

Presenter(s):

Sally Edwards

Staff Trainer
7101 Wisconsin Avenue, Suite 700
Bethesda, MD 20814

Phone: 301-634-0818
FAX: 301-657-0250
E-Mail: litalk@teachingstrategies.com

CONCURRENT PRESENTATIONS

THURSDAY, JULY 21, 2011

10:15 A.M. - 11:45 A.M.

23. More Than Recess: Creating A Successful Outdoor Classroom In A Southern Climate

Regency V

The warm southern climate allows early childhood programs the opportunity to make the most of outdoor play experiences. An overview of research and best practice that supports outdoor play and utilizes the "Three Kinds of Play" will be discussed. This presentation will provide participants with the ideas and knowledge to implement quality developmentally appropriate outdoor fluid, dramatic, and structured construction play experiences.

Program Track: Child Growth and Development

Target Audience: Administrators, Directors, Teachers: New and Experienced

Domain (Standard): Physical Development
Approaches to Learning
Social and Emotional Development
Language, Communication and Emergent Literacy
Cognitive Development and General Knowledge

Core Competencies: Teaching and Learning Environments and Interactions
Curriculum

Presenter(s):

Pamela C. Phelps, Ph.D., *Consultant for Creative Center for Childhood Research & Training, Inc.*

Director of The Creative Pre-School
2746 West Tharpe Street
Tallahassee, FL 32303

Phone: 850-422-1080
FAX: 850-422-1283
E-Mail: cccr@comcast.net

24. You Should KNOW Better! Helping Children Accept Responsibility For Their Choices

Regency VI

This presentation will help participants understand what's behind "misbehavior" and how judgment and shame interfere with the ability to accept responsibility. They will discover how to help children accept, see, and own their mistakes through the skill of noticing, allowing them to access the higher centers of their brains to problem solve and KNOW what to do in the future.

Program Track: Mental Health/Managing Behaviors

Target Audience: Administrators, Directors, Teachers: New and Experienced

THURSDAY, JULY 21, 2011

10:15 A.M. - 11:45 A.M.

Domain (Standard): Social and Emotional Development

Core Competencies: Child Development and Learning
Teaching and Learning Environments and Interactions

Presenter(s):

Ginny Luther, Behavioral Consultant
Peaceful Parenting, LLC
480 NE Lima Vias
Jensen Beach, FL 34957

Phone: 772-225-1471
FAX: 772-225-1471
Email: ginnyluther@peacefulparenting.net

25. Obesity In Children: Are You The Problem Or The Solution? Regency VII

With 27% of the world's children considered obese and numbers higher in minorities, this presentation will address frequency of obesity, implications of health, emotional and social issues, and provide both classroom and take-home strategies for changing and maintaining good nutrition and eating habits. Learn nutrition risk indicators and a new way of viewing the food pyramid. Find out about what you can do with challenging mealtime behaviors. Great hands-on activities, handouts, and resources for free materials.

Program Track: Health, Safety and Nutrition

Target Audience: Direct Service Providers, Directors, Family Support, Training and Technical Staff

Domain (Standard): Physical Development

Core Competencies: Health, Safety and Nutrition
Child Development and Learning

Presenter(s):

Bethany Sands, *Inclusion/Assessment Program Director*
Early Learning Coalition of Miami-Dade/Monroe
2555 Ponce de Leon Boulevard, Suite 500
Coral Gables, FL 33134

Phone: 305-646-7248
FAX: 305-447-1608
E-Mail: bsands@elcmdm.org

Alina Soto, B.A.
Early Learning Coalition of Miami-Dade/Monroe
2555 Ponce de Leon Boulevard, Suite 500
Coral Gables, FL 33134

Phone: 786-942-2546
FAX: 305-447-1608
E-Mail: sampudia@elcmdm.org

THURSDAY, JULY 21, 2011

10:15 A.M. - 11:45 A.M.

26. 2011 State And Federal Legislative Review

Buccaneer B

The 2011 State and Federal Legislative Panel will be comprised of representatives from public and private sector organizations that are involved in the early care and education arena. Each panelist will provide a brief overview of budget and substantive issues addressed by the 2011 Florida Legislature and Congress impacting their particular organization/state agency, and associated rules and regulations that may be developed or impacted. Questions from the audience will be addressed by panelists following the overviews.

Program Track: Public Policy and Advocacy

Target Audience: Administrators, Direct Service Providers, Directors,
Teachers: New and Experienced, Training and Technical Staff

Core Competencies: Professionalism

Presenter(s):

Theodore Granger, *President*

United Way of Florida
307-B East Seventh Avenue
Tallahassee, FL 32303

Phone: 850-488-8276
FAX: 850-681-9137
E-Mail: tgranger@uwof.org

Brittany Olivieri Birken, *Ph.D., Executive Director*

Florida Children's Services Council
216 South Monroe Street
Tallahassee, FL 32301

Phone: 850-402-5437, ext. 1
Fax: 850-942-5437
Email: bbirken@floridacsc.org

Lilli Copp, *Director*

Florida Head Start Collaboration Office
600 South Calhoun Street, Suite 202
Tallahassee, FL 32399

Phone: 850-921-3467
FAX: 850-488-7099
E-Mail: lilli.copp@flaawi.com

Stuart Greenberg, *Executive Director*

Florida Department of Education, Office of Early Learning
325 West Gaines Street, Suite 514
Tallahassee, FL 32399-0400

Phone: 850-245-0445
FAX: 850-245-5105
E-Mail: Stuart.Greenberg@fldoe.org

Phyllis Kalifeh, *President/CEO*

Children's Forum
2807 Remington Green Circle
Tallahassee, FL 32308

Phone: 850-681-7002
FAX: 850-681-9816
E-Mail: pkalifeh@thechildrensforum.org

THURSDAY, JULY 21, 2011

10:15 A.M. - 11:45 A.M.

Alisa Ghazvini, Ph.D.
Early Childhood Consultant
1462 Mitchell Avenue.
Tallahassee, FL 32303

Phone: 850-545-7716
FAX: 850-893-0683
E-Mail: aghazvini@hotmail.com

Diana Ragbeer, Director of Public Policy & Communications
The Children's Trust
3150 SW 3rd Avenue
Miami, FL 33129

Phone: 305-571-5700
E-Mail: diana.ragbeer@thechildrenstrust.org

Deborah Russo, Director
Florida Department of Children and Families
1317 Winewood Boulevard, Building 6, 3rd Floor
Tallahassee, FL 32399

Phone: 850-488-4900
FAX: 850-414-7974
E-Mail: Debby.Russo@doh.state.fl.us

Michele Watson, ELIS Programmatic Director
Agency for Workforce Innovation, Office of Early Learning
107 East Madison Street, MSC 140
Tallahassee, FL 32399

Phone: 850-617-0651
FAX: 850-921-3188
E-Mail: Michele.Watson@flaawi.com

27. Leadership In Action - How To Walk Your Talk

Buccaneer D

In this interactive session, participants will learn how to "walk their talk" and explore the idea that leadership has more to do with how they behave than with their titles or what they say.

Program Track: Management and Leadership

Target Audience: Administrators, Directors, Teachers: Experienced

Core Competencies: Professionalism

Presenter(s):

Sartura Shuman-Smith, Consultant/Professional Facilitator
JAS Consulting
1002 North Oregon Avenue
Tampa, FL 33607

Phone: 813-900-6452
E-Mail: sarturasmith@gmail.com

28. Literacy Enhancement For Early Readers: How To Provide Playful Literacy Opportunities In The Preschool Classroom

Esplanade I

The Early Reading First Project Literacy Enhancement for Early Readers team of Early Literacy Specialists will discuss the research based Scaffolding Early Literacy approach. Pictures and videos of how this approach looks in diverse preschool classrooms will provide participants with practical examples of how to playfully increase early literacy activities in preschool settings.

Program Track: Developmentally Appropriate Curriculum

Target Audience: Teachers: New and Experienced

THURSDAY, JULY 21, 2011

10:15 A.M. - 11:45 A.M.

Domain (Standard): Language, Communication and Emergent Literacy

Core Competencies: Teaching and Learning Environments and Interactions
Curriculum

Presenter(s):

Maria Serra, Senior Project Manager, Early Reading First Project L.E.E.R.

United Way Center for Excellence in Early Education Phone: 305-213-4446
3250 SW 3rd Avenue FAX: 305-631-7641
Miami, FL 33129-2712 E-Mail: serram@unitedwaymiami.org

Miriam Altman, Early Learning Specialist

United Way Center for Excellence in Early Education Phone: 786-382-1863
3250 SW 3rd Avenue FAX: 305-631-7641
Miami, FL 33129-2712 E-Mail: altmanm@unitedwaymiami.org

Maria Cabrera, Early Learning Specialist

United Way Center for Excellence in Early Education Phone: 786-417-7984
3250 SW 3rd Avenue FAX: 305-631-7641
Miami, FL 33129-2712 E-Mail: cabreram@unitedwaymiami.org

Luisa Cotto, Early Learning Specialist

United Way Center for Excellence in Early Education Phone: 813-482-7641
3250 SW 3rd Avenue FAX: 305-631-7641
Miami, FL 33129-2712 E-Mail: cottol@unitedwaymiami.org

**29. Child Care Resource and Referral (CCR&R) Is The
Front Door To Family Services**

Esplanade II

Child Care Resource and Referral (CCR&R) is the front door to all family services and typically a new parent's first encounter with the world of early learning. CCR&R Intake Specialists play a critical role in sharing information that families need to make an informed choice about child care. Learn how to successfully blend CCR&R with eligibility and other programs in your agency. This presentation will provide an overview of the CCR&R process and highlight service delivery models that promote a "CCR&R is the Front Door" policy for family services as well as promote data integrity to prepare participants for the new Early Learning Information System (ELIS).

Program Track: Family Involvement and Support

Target Audience: Family Support

Core Competencies: Building Family and Community Relationships
Professionalism

Presenter(s):

Gerie Nasche, Director of CCR&R Family Support Services

Agency for Workforce Innovation, Office of Early Learning Phone: 850-921-3199
107 East Madison Street, MSC #140 FAX: 850-921-3188
Tallahassee, FL 32399 E-Mail: gerie.nasche@flaawi.com

THURSDAY, JULY 21, 2011

10:15 A.M. - 11:45 A.M.

Marilyn Hibbard, *State CCR&R Network Administrator*
Agency for Workforce Innovation, Office of Early Learning
107 East Madison Street, MSC #140
Tallahassee, FL 32399

Phone: 850-617-5606
FAX: 850-921-3188
E-Mail: marilyn.hibbard@flaawi.com

30. Early Signs Of Autism

Esplanade III

Participants will get an understanding of the early signs of autism spectrum disorder and how the disorder affects the ability to function in all aspects of society. Furthermore, they will learn the typical developmental stages of young children and how a young child with autism may hit the developmental milestones at various ages and stages compared to a typically developing child. The participants will leave the session knowing about the state's legal obligation to meet the needs of young children with special needs and discuss various resources for children, families, and educators.

Program Track: Special Needs and Inclusion

Target Audience: Family Support, Teachers: New

Domain (Standard): Physical Development

Core Competencies: Health, Safety and Nutrition
Observing, Documenting, Screening, and Assessing to
Support Young Children and Their Families

Presenter(s):

Terri Shermett, *Preschool ESE Coordinator*
School Board Broward County
600 SE Third Avenue, 9th Floor
Fort Lauderdale, FL 33301

Phone: 754-321-1956
FAX: 754-321-2715
E-Mail: terri.shermett@browardschools.com

31. Teaching How Children Learn - Not How You Teach Them

Garrison I-III

This presentation highlights the different learning styles of young children that are often misinterpreted by busy teachers as defiance or lack of interest. Without realizing it, teachers may teach in the style THEY learned in and then cannot understand why the children are not engaged. Participants will gain practical ideas combined with inexpensive techniques that ignite the child's learning brain, allowing children and teachers to be successful.

Program Track: Child Growth and Development

Target Audience: Teachers: New and Experienced

Domain (Standard): Approaches to Learning
Social and Emotional Development
Language, Communication and Emergent Literacy
Cognitive Development and General Knowledge

Core Competencies: Child Development and Learning
Teaching and Learning Environments and Interactions

THURSDAY, JULY 21, 2011

10:15 A.M. - 11:45 A.M.

Presenter(s):

Lynne Eldridge, *Executive Director*
Early Learning Coalition of Northwest Florida
703 West 15th Street, Suite A
Panama City Beach, FL 32401

Phone: 850-747-5400
FAX: 850-747-5450
E-Mail: lynne.eldridge@elcofnwflorida.org

32. All The Write Moves

City Center
(located first floor, hotel registration lobby)

Join me as we explore the writing experience of a preschool child and how our classrooms can get back onto the writing wagon. We will also look into writing benchmarks from our state standards to better understand how they can benefit the writing adventures in early childhood. Some of our activities will include: exploration of literacy-rich classrooms, development of interactive charts, materials to organize a writing center, environment print, and how to pack a literacy suitcase. Come watch everyday trash turned into just the WRITE treasure!

Program Track: Developmentally Appropriate Curriculum

Target Audience: Administrators, Direct Service Providers, Directors,
Teachers: New and Experienced, Training and Technical Staff

Domain (Standard): Language, Communication and Emergent Literacy

Core Competencies: Teaching and Learning Environments and Interactions
Curriculum

Presenter(s):

Priscilla Jones, *Early Childhood Consultant*
PB&J Preschool Consulting Services
8917 256th Trail
Obrien, FL 32071

Phone: 386-935-1386
E-Mail: pbjpreschool@yahoo.com

THURSDAY, JULY 21, 2011

12:00 NOON-1:15 P.M. RESEARCH PRESENTATION

Regency II

Presiding: Alisa Ghazvini
One Goal Summer Conference Committee
Tallahassee, Florida

Keynote Speaker: Daryl B. Greenfield, Ph.D.
Professor, Department of Psychology and Pediatrics
University of Miami



Daryl B. Greenfield, Ph.D., a nationally recognized expert in early childhood research, is a Professor of Psychology and Pediatrics at the University of Miami in Coral Gables, Florida. Dr. Greenfield has participated in a number of statewide initiatives including serving as an advisor to the AWI Office of Early Learning, working on Florida's initial birth to three early learning standards and 3 to 5 year-old school readiness standards and the more recent statewide effort to integrate birth to three, 3 to 5, and VPK standards into a single set of state standards. For the past three decades, Dr. Greenfield's research has focused on using data to inform program practices to improve the school readiness of low income minority children served by programs such as Head Start. His currently funded research projects include

a randomized control trial evaluation of the Early Childhood Hands on Science Program (ECHOS) in partnership with the Miami Dade County Head Start/Early Head Start program and the Miami Museum of Science, the development of a computer adaptive science assessment for preschool children delivered on a touch-screen laptop, in partnership with the Miami Dade County Head Start/Early Head Start program, and serving as the United Way of Miami Center for Excellence in Early Education's research partner in the National Bounce Learning Network Implementation Study.

Address: 340 Fred C. and Helen Donn Fipse Building, 5665 Ponce de Leon Boulevard, Coral Gables, FL 33146, E-Mail: dgreen@miami.edu

CONCURRENT PRESENTATIONS

THURSDAY, JULY 21, 2011

1:30 P.M. - 2:30 P.M.

33. Sensory Art Experiences For Infants And Toddlers

Regency V

Children learn best through play and exploration. Art provides opportunities for children to explore with their senses. Scientific research confirms the benefits of using art materials to stimulate a toddler's developing brain. Children reach developmental milestones through the process of art. This presentation will give its participants numerous ideas for safe and exciting art experiences that can be done with this age group. New and innovative ways to display children's art in the classroom that are in line with the Infant/Toddler Environmental Rating Scale will also be covered.

Program Track: Developmentally Appropriate Curriculum

Target Audience: Directors, Teachers: New and Experienced

Domain (Standard): Physical Development
Approaches to Learning
Social and Emotional Development
Language, Communication and Emergent Literacy
Cognitive Development and General Knowledge

Core Competencies: Teaching and Learning Environments and Interactions
Curriculum

Presenter(s):

Melissa Bradshaw, *Early Head Start Teacher*

Lee County Schools
15963 Auk Way
Bonita Springs, FL 34135

Phone: 239-357-0959
E-Mail: melissacb@leeschools.net

Angie Arnold, *Assistant Early Head Start Teacher*

Lee County Schools
3617 Pine Oak Circle, #101
Fort Myers, FL 33916

Phone: 239-470-2484
E-Mail: angelada@leeschools.net

34. Voluntary Prekindergarten (VPK) Assessment Overview

Regency VI

Participants will receive information about the Florida Voluntary Prekindergarten (VPK) Assessment which may be used in conjunction with many broad screening tools, but specifically looks at emergent reading, mathematical thinking, and language/vocabulary skills. This session will primarily focus on early literacy skills and how the assessment tool can be administered by teachers and used to assist in planning instruction to meet children's needs.

Program Track: Screenings/Assessments/Evaluations

Target Audience: Administrators, Directors, Teachers: New and Experienced

Core Competencies: Observing, Documenting, Screening, and Assessing to Support Young Children and Their Families

THURSDAY, JULY 21, 2011

1:30 P.M. - 2:30 P.M.

Presenter(s):

Melinda Webster, *Director, Program Standards and Professional Development*
Florida Department of Education, Office of Early Learning Phone: 850-245-7808
325 West Gaines Street, Suite 514 FAX: 850-245-5105
Tallahassee, FL 32399 E-Mail: melinda.webster@fldoe.org

Tara Huls, *Ph.D., Educational Policy Consultant*
Florida Department of Education, Office of Early Learning Phone: 850-245-5037
325 West Gaines Street, Suite 514 FAX: 850-245-5105
Tallahassee, FL 32399 E-Mail: tara.huls@fldoe.org

35. Science: Before And AFTER! Regency VII

Young children are enthusiastic explorers of their world, bringing a sense of wonder to their work and play. A good science program for young children develops from a carefully designed environment. The program has specific goals, which incorporate the children's interests and questions. Join us for an interactive presentation that will provide participants with information on the importance of teaching science, the materials needed to enhance the child's natural desire to explore, and many hands-on activities.

Program Track: Developmentally Appropriate Curriculum
Target Audience: Teachers: New and Experienced
Domain (Standard): Cognitive Development and General Knowledge
Core Competencies: Teaching and Learning Environments and Interactions
Curriculum

Presenter(s):

Jennifer Mead, *Resource Specialist*
Early Learning Coalition of St. Lucie County Phone: 772-595-6424
804 South 6th Street FAX: 772-595-6081
Fort Pierce, FL 34950 E-Mail: zobiej01@elcslc.org

Linda Greenstein, *Resource Specialist*
Early Learning Coalition of St. Lucie County Phone: 772-595-6424
804 South 6th Street FAX: 772-595-6081
Fort Pierce, FL 34950 E-Mail: greensteinl01@elcslc.org

36. Educating Our Practitioners Is Just A Click Away! Buccaneer A

Distance learning's future is very bright, and a good investment opportunity as well. The Early Learning Coalition of the Big Bend Region has taken an innovation approach to encourage practitioners to get involved in professional development. Teachers use the knowledge and skills learned in the courses and apply them to real life situations in their early childhood programs. This informative session demonstrates the ELC's Learning Management System and will spark your interest in getting on board with Distance Learning; after all, it's just a click away!

THURSDAY, JULY 21, 2011

1:30 P.M. - 2:30 P.M.

Program Track: Management and Leadership

Target Audience: Administrators, Directors, Training and Technical Staff

Core Competencies: Professionalism

Presenter(s):

Kathy Douglas, *Distance Education & Research Director*

Early Learning Coalition of the Big Bend

3705 Anthony Drive

Tallahassee, FL 32309

Phone: 850-893-6736

E-Mail: kdouglas@elcbigbend.org

37. Book Nook

Buccaneer B

This presentation provides examples of activities that can be used while reading books and throughout the day to promote social and emotional development. Reading the same book for several days in a row is a great way to provide opportunities for infants, toddlers, and preschoolers to develop a sense of competence and confidence which is an important part of social and emotional development.

Program Track: Child Growth and Development

Target Audience: Family Support, Teachers: New and Experienced

Domain (Standard): Language, Communication and Emergent Literacy

Core Competencies: Teaching and Learning Environments and Interactions
Curriculum

Presenter(s):

Damaris Conner, *Inclusion Specialist*

Pasco-Hernando Early Learning Coalition

286 Benes Road Masaryktown

Brooksville, FL 34604

Phone: 352-454-2309

FAX: 727-857-0151

E-Mail: d.conner@phelc.org

**38. Communicating With The English Language Learner
In Your Care**

Buccaneer C

We have become a nation of many different cultures and nationalities. Children come to us with many different languages and we cannot possibly have an interpreter for everyone. We need to have strategies in place that will help us communicate with the children in our care and help them to learn. This presentation will provide the strategies you need to communicate with the English Language Learner in your classroom.

Program Track: Cultural Diversity/Multicultural Education

Target Audience: Directors, Teachers: New and Experienced

Domain (Standard): Language, Communication and Emergent Literacy

THURSDAY, JULY 21, 2011

1:30 P.M. - 2:30 P.M.

Core Competencies: Child Development and Learning
Teaching and Learning Environments and Interactions

Presenter(s):

Patty Lister, *Training and Development Specialist*
Early Learning Coalition of Pinellas County
5735 Rio Vista Drive
Clearwater, FL 33760

Phone: 727-548-1439, ext. 228
FAX: 727-548-1509
E-Mail: plister@elcpinellas.net

**39. KidVision Voluntary Prekindergarten - VPK Standards
Professional Development And Classroom Tools**

Buccaneer D

KidVision VPK is an exciting new way of learning and teaching the VPK Education Standards using researched methodologies and new technology. KidVision VPK serves the early childhood community by providing FREE online in-service hours and CEUs, classroom support, and parent involvement materials. KidVision VPK is presented in thematic units. Each unit includes a virtual field trip, 4 VPK Standards lesson plans, 4 student assessment forms, and 2 take-home pages. KidVision VPK adds a stimulating new dimension to learning and teaching the VPK Standards. It is FREE. Come to the presentation and experience the fun! Participants will practice using KidVision VPK materials in the classroom.

Program Track: Developmentally Appropriate Curriculum

Target Audience: Directors, Family Support, Teachers: New and Experienced

Domain (Standard): Language, Communication and Emergent Literacy
Cognitive Development and General Knowledge

Core Competencies: Child Development and Learning
Professionalism

Presenter(s):

Penny Bernath, *Education Content Producer for KidVision VPK*
WPBT2
3326 H Farragut Street
Hollywood, FL 33021

Phone: 954-873-4824
E-Mail: pennybernath@hotmail.com

40. KidSafe - Information All Teachers Need To Know

Esplanade I

Join KidSafe as we take you on a journey of personal safety prevention education. Through humor and dedication to the safety of children, we will teach you skills to raise awareness of the safety issues children face today, including: predator awareness, signs and symptoms of children in need, and a language of safety to teach young children. Participants will gain a better understanding of who the predators are, why we don't use the term "stranger," and concrete safety skills to teach your young children in the classroom.

Program Track: Health, Safety and Nutrition

Target Audience: Directors, Family Support, Teachers: New and Experienced

THURSDAY, JULY 21, 2011

1:30 P.M. - 2:30 P.M.

Domain (Standard): Physical Development

Core Competencies: Health, Safety and Nutrition

Presenter(s):

Cherie Benjoseph, *Licensed Clinical Social Worker*

KidSafe Foundation

5944 Coral Ridge Drive, #241

Coral Springs, FL 33076

Phone: 561-756-2171

E-Mail: cherieb@kids safefoundation.org

41. Bridging The Gap

Esplanade II

The purpose of this presentation is for families, educators, and professionals to understand that sometimes the issues keeping them from a collaborative, team building relationship are much more similar than they might have thought. We will look at Culture, Language, Involvement, Outreach, Trust, and Authority. We will also explore how all of these factors are key issues in Bridging the Gap between families, educators, and professionals, to develop a wonderful working relationship.

Program Track: Family Involvement and Support Collaboration

Target Audience: Direct Service Providers, Directors, Family Support, Teachers: New and Experienced, Training and Technical Staff

Core Competencies: Building Family and Community Relationships

Presenter(s):

Marilyn Ruiz, *Outreach Coordinator/Multi Cultural Specialist*

Family Network on Disabilities

2196 Main Street , Suite K

Dunedin, FL 34698

Phone: 727-523-1130

FAX: 727-523-8687

E-Mail: marilyn@fndfl.org

42. The Journey To Quality

Esplanade III

What are some of the most important components needed to assist providers to move towards quality? Florida Early Learning and Development Standards? Early Childhood Environment Rating Scales? Core Competencies for Directors and Practitioners? After reviewing and analyzing QIS data collected over the past four years, the Early Learning Coalition of Sarasota County has identified key components that make a difference in providers progressing towards this goal. We will discuss what has been found to be the critical elements, including: training linked to core competencies with follow-up activities; mentoring and target assistance; materials/resources; community collaboration; and relationship building.

Program Track: Management and Leadership

Target Audience: Administrators, Training and Technical Staff

Core Competencies: Professionalism

THURSDAY, JULY 21, 2011

1:30 P.M. - 2:30 P.M.

Presenter(s):

Claudia Malecki, *Quality Programs Manager*
Early Learning Coalition of Sarasota County
1750 17th Street, Building L
Sarasota, FL 34234

Phone: 941-954-4839, ext. 109
FAX: 941-954-4831

E-Mail: cmalecki@earlylearningcoalitionsarasota.org

Dianne Lawrence, *Program Manager*
Early Learning Coalition of Sarasota County
1750 17th Street, Building L
Sarasota, FL 34234

Phone: 941-954-4830, ext. 223
FAX: 941-954-4831

E-Mail: dlawrence@earlylearningcoalitionsarasota.org

Candy Exline, *Early Childhood Specialist*
Early Learning Coalition of Sarasota County
1750 17th Street, Building L
Sarasota, FL 34234

Phone: 941-954-4830, ext. 226
FAX: 941-954-4831

E-Mail: cexline@earlylearningcoalitionsarasota.org

43. Let's Make Some Music!

Garrison I-III

(Session Repeated, #57)

Tired of the same old song? This is the presentation for you! A voices and hands-on presentation full of original and old favorite songs and activities with a twist. Come ready to participate and you will leave with a new repertoire of songs and activities that you can use in your classroom with pre-school learners of all abilities.

Program Track: Special Needs and Inclusion
Developmental Appropriate Curriculum

Target Audience: Direct Service Providers, Teachers: New and Experienced

Domain (Standard): Physical Development
Approaches to Learning
Social and Emotional Development
Language, Communication and Emergent Literacy
Cognitive Development and General Knowledge

Core Competencies: Teaching and Learning Environments and Interactions
Curriculum

Presenter(s):

Nancy Lenzen Davis, *MT-BC*
Board Certified Music Therapist
160 Sam Green Road
Coventry, CT 06238

Phone: 860-888-4631
FAX: 860-742-9366 (not dedicated)
E-Mail: Jayhawk378@aol.com

THURSDAY, JULY 21, 2011

1:30 P.M. - 2:30 P.M.

44. T.E.A.C.H. And WAGE\$: Hand-In-Hand Programs Encouraging Professional Development Within Your Child Care Program

Ybor

This presentation will advise early child care professionals of scholarship opportunities available to their child care program to assist with professional development. The presentation will provide information on possible salary supplements for eligible staff members once certain levels of education have been attained. The participant will identify how best to meet her/his child care program educational and professional goals with the help of the T.E.A.C.H. scholarship and will determine if salary supplements are available to their child care program via the WAGE\$ program.

Program Track: Management and Leadership

Target Audience: Administrators, Direct Service Providers, Directors,
Teachers: New and Experienced

Core Competencies: Professionalism

Presenter(s):

Lori Stegmeyer, *Director of Workforce Initiatives*
Children's Forum
2807 Remington Green Circle
Tallahassee, FL 32308

Phone: 850-681-7002
FAX: 850-410-0394

E-Mail: lstegmeyer@thechildrensforum.com

Kiki Carter, *WAGE\$ Coordinator*
Children's Forum
2807 Remington Green Circle
Tallahassee, FL 32308

Phone: 850-681-7002
FAX: 850-922-8699

E-Mail: qcarter@thechildrensforum.com

45. Chillers, Thrillers And Time Fillers

City Center

(located first floor, hotel registration lobby)

Many preschool students struggle during transition times. When a child is playing at home, they are able to make the decision whether to play or not to play or move to another activity; however in the preschool classroom that is not often the case. Very often the class moves as a group to other activities. Delays in the routine and extended transition times often breed disruptive behavior. This session will give effective, practical, and low cost ways to make transition times smoother. It will also suggest ways to use wait times as an extension of classroom learning time, as well as ways to keep a positive tone in the classroom at all times.

Program Track: Developmentally Appropriate Curriculum

Target Audience: Teachers: New

Domain (Standard): Approaches to Learning
Social and Emotional Development

Core Competencies: Teaching and Learning Environments and Interactions

THURSDAY, JULY 21, 2011

1:30 P.M. - 2:30 P.M.

Presenter(s):

Pam Vosbrink, Director
The Preschool at Point Washington
1290 North County Hwy 395
Santa Rosa Beach, FL 32459

Phone: 850-231-5439
FAX: 850-231-3280
E-Mail: preschoolpwumc@gmail.com

Claire Hudson, K-4 Teacher
The Preschool at Point Washington
139 Rosemary Avenue
Rosemary Beach, FL 32461

Phone: 850-231-5439
FAX: 850-231-3280
E-Mail: chudson0502@gmail.com

Dawn Nowak, K-3 Teacher
The Preschool at Point Washington
2271 Lakeview Drive
Panama City Beach, FL 32413

Phone: 850-231-5439
FAX: 850-231-3280
E-Mail: preschoolpwumc@gmail.com

CONCURRENT PRESENTATIONS

THURSDAY, JULY 21, 2011

2:45 P.M. - 3:45 P.M.

46. Character By The Book

Regency II

This fun-filled session will use popular children's literature to address key character concepts in the preschool classroom. Traits such as responsibility, tolerance, cooperation, empathy, and generosity will be presented in a developmentally appropriate context.

Program Track: Developmentally Appropriate Curriculum

Target Audience: Directors, Teachers: New and Experienced

Domain (Standard): Approaches to Learning
Social and Emotional Development

Core Competencies: Teaching and Learning Environments and Interactions
Curriculum

Presenter(s):

Suzanne Adinolfi, *Education/Inclusion Specialist*
Early Learning Coalition of Northwest Florida
9215 Faith Lane
Panama City Beach, FL 32407

Phone: 773-425-2564
FAX: 850-747-5450
E-Mail: sdadinolfi@yahoo.com

Donna Whittaker, *Education/Infant Toddler Specialist*
Early Learning Coalition of Northwest Florida
703 West 15th Street, Suite A
Panama City, FL 32401

Phone: 850-866-3767
FAX: 850-747-5450
E-Mail: donna.whittaker@elcofnwflorida.org

47. It's All About Teaching - Strategies To Reduce Challenging Behaviors And Improve The Quality Of Your Early Childhood Program!

Regency V

An early childhood program should feel nurturing, supportive, and safe. Creating a positive environment means using age-appropriate discipline strategies. The strategies presented in this Time to Teach presentation are practical, powerful, and ready to use. Time to Teach will immediately empower your early childhood program to increase on-task performance, decrease discipline challenges, and gain parental support. The goal of discipline is not to punish, but rather to TEACH!

Program Track: Mental Health/Managing Behaviors

Target Audience: Administrators, Direct Service Providers, Directors, Family Support, Teachers: New and Experienced, Training and Technical Staff

Domain (Standard): Physical Development
Approaches to Learning
Social and Emotional Development

THURSDAY, JULY 21, 2011

2:45 P.M. - 3:45 P.M.

Core Competencies: Child Development and Learning
Teaching and Learning Environments and Interactions

Presenter(s):

Cheryl Fox Weber, Associate Trainer

Time To Teach

2298 Primrose Lane, #1303

Clearwater, FL 33763

Phone: 727-479-8869

E-Mail: cherylfoxweber.principal@yahoo.com

**48. Florida Kindergarten Readiness Screener (FLKRS) And
The Voluntary Prekindergarten (VPK) Readiness Rate**

Regency VI

This presentation will outline the accountability system for Florida's Voluntary Prekindergarten (VPK) Education Program and how VPK providers' readiness rates are calculated. Information about the components of the Florida Kindergarten Readiness Screener (FLKRS) will also be shared with participants.

Program Track: Screenings/Assessments/Evaluations

Target Audience: Administrators, Directors, Teachers: New and Experienced

Core Competencies: Observing, Documenting, Screening, and Assessing to
Support Young Children and Their Families

Presenter(s):

Melinda Webster, Director, Program Standards and Professional Development

Florida Department of Education, Office of Early Learning

325 West Gaines Street, Suite 514

Tallahassee, FL 32399

Phone: 850-245-7808

FAX: 850-245-5105

E-Mail: melinda.webster@fldoe.org

Tara Huls, Ph.D., Educational Policy Consultant

Florida Department of Education, Office of Early Learning

325 West Gaines Street, Suite 514

Tallahassee, FL 32399

Phone: 850-245-5037

FAX: 850-245-5105

E-Mail: tara.huls@fldoe.org

**49. Promoting Physical Activity Among Young Children
With Autism Spectrum Disorders**

Regency VII

All children deserve the opportunity to play and be physically active. Children with autism often have limited opportunities to actively engage in functional physical activity. This session will discuss the signs and symptoms of Autism Spectrum Disorders (ASD) while providing attendees with functional strategies to include these students in physical activity.

Program Track: Special Needs and Inclusion

Target Audience: Administrators, Direct Service Providers, Directors, Family
Support, Teachers: New and Experienced, Training and
Technical Staff

Domain (Standard): Physical Development

THURSDAY, JULY 21, 2011

2:45 P.M. - 3:45 P.M.

Core Competencies: Teaching and Learning Environments and Interactions

Presenter(s):

Shelton Gilyard, Jr., *Autism Consultant*
University of South Florida
13301 Bruce B. Downs Boulevard
Tampa, FL 33594

Phone: 813-974-6441
FAX: 813-974-6115
E-Mail: sgilyard@usf.edu

50. A Prime Time Family Experience!

Buccaneer A

PRIME TIME FAMILY READING TIME was developed by The Louisiana Endowment for the Humanities in 1991, and 20 years later it is still going strong! In Florida, PRIME TIME is supported through grant funding by the Florida Humanities Council. Join representatives from two different public libraries to learn how PRIME TIME English and Spanish programs changed lives in urban Orange County and rural Plant City. They will illustrate how storytelling and humanities-based discussion helped libraries forge family relationships and connect with parents and children; and most importantly, helped families find a love of reading and the library together.

Program Track: Family Involvement and Support
Collaboration

Target Audience: Direct Service Providers, Family Support, Teachers: New
and Experienced

Core Competencies: Building Family and Community Relationships

Presenter(s):

Kelly Pepo, *Branch Manager*
Orange County Library System
5049 Edgewater Drive
Orlando, FL 32810

Phone: 407-835-7323, ext. 6422
FAX: 407-835-7647
E-Mail: pepo.kelly@ocls.info

Anne Haywood, *Library Directory*
Bruton Memorial Library
302 West McLendon Street
Plant City, FL 33563

Phone: 813-757-9215
FAX: 813-757-9217
E-Mail: ahaywood@plantcitygov.com

51. Bringing The Story To Life!

Buccaneer B

Research supports the practice of reading aloud to children as the single most important activity for preparing young children to become readers. Learn how to create an effective interaction with young children during story time. In this session, presenters will address questioning techniques and effective teaching strategies to engage diverse learners during a read aloud. Participants will be encouraged to participate in small group activities to develop age appropriate activities using popular children's literature. Participants will learn how to make interactions with preschoolers most beneficial.

Program Track: Developmentally Appropriate Curriculum

THURSDAY, JULY 21, 2011

2:45 P.M. - 3:45 P.M.

Target Audience: Family Support, Teachers: New
Domain (Standard): Language, Communication and Emergent Literacy
Core Competencies: Teaching and Learning Environments and Interactions Curriculum

Presenter(s):

Vera Meyerholtz, *Early Literacy Teacher*
Nemours BrightStart!
10140 Centurion Parkway North
Jacksonville, FL 32256

Phone: 904-697-4193
E-Mail: esmeyerh@nemours.org

**52. Early Learning Information System (ELIS) Overview
And Focus Group**

Buccaneer C

This session will provide an interactive overview of the Early Learning Information System, ELIS. The presentation will focus on the design and development of the provider portal which will be a web-based technology system that will allow School Readiness and Voluntary Prekindergarten (VPK) providers to manage administration of their programs.

Program Track: Public Policy and Advocacy
Target Audience: Administrators, Direct Service Providers, Directors, Family Support
Core Competencies: Professionalism

Presenter(s):

Michele Watson, *ELIS Programmatic Director*
Agency for Workforce Innovation, Office of Early Learning
107 East Madison Street, MSC 140
Tallahassee, FL 32399

Phone: 850-617-0651
FAX: 850-921-3188
E-Mail: Michele.Watson@flaawi.com

53. Training Practitioners In Effective Professional Development

Buccaneer D

This session will explore the design and implementation of the statewide professional development non-credit course that has become the foundation of the Florida Steps to Success Early Learning Career Pathways. The session helps trainers, directors, and practitioners understand how reflective practice and the use of practitioner core competencies can positively influence the professional growth of practitioners as they target key skill and knowledge areas for self-improvement.

Program Track: Management and Leadership
Target Audience: Directors, Teachers: New and Experienced, Training and Technical Staff
Core Competencies: Professionalism

THURSDAY, JULY 21, 2011

2:45 P.M. - 3:45 P.M.

Presenter(s):

David Wells, *Education Coordinator*
Palm Beach State College
812 Fern Street
West Palm Beach, FL 33401

Phone: 561-740-7011, ext. 3365
FAX: 561-868-7042
E-Mail: wells@d@palmbeachstate.edu

Darcy Russo, *Early Learning Training Center Director*
Palm Beach State College
812 Fern Street
West Palm Beach, FL 33401

Phone: 561-868-3663
FAX: 561-868-7042
E-Mail: russod@palmbeachstate.edu

54. Using Self-Assessment To Close The Loop

Esplanade I

Quality child care does not happen by accident. Successful businesses, large and small, have a plan. What is your plan? How well is it working? How do you know? In this ever changing world, early childhood programs must continually self-assess to ensure they are meeting the needs of the children, families, and staff. By asking the right questions and reviewing the data, program leaders can make informed decisions to improve the quality of their program. These decisions can help retain staff and families. During this presentation, several tools and ideas will be shared to help program administrators perform self-assessments.

Program Track: Management and Leadership

Target Audience: Administrators, Directors

Core Competencies: Teaching and Learning Environments and Interactions
Professionalism

Presenter(s):

Tara Orlowski, *Early Childhood Program Director/Institutional Effectiveness*

North Florida Community College
325 NW Turner Davis Drive, Building 5, Room 101A
Madison, FL 32340

Phone: 850-973-1789
FAX: 850-973-1684
E-Mail: orlowskit@nfcc.edu

**55. The Licensing Counselor's Role In Ensuring Health
And Safety In Child Care Settings**

Esplanade II

This presentation will focus on the health and safety of pre-school children as viewed through the tasks of a child care licensing counselor. Participants will learn what a child care counselor does, how they go about completing their tasks, and why they do what they do. The presentation will inform attendees of the challenges faced by licensing counselors as they work to ensure the health and safety of children attending licensed child care facilities. Attendees will gain a better understanding of the role counselors play in the business of child care.

Program Track: Health, Safety and Nutrition

THURSDAY, JULY 21, 2011

2:45 P.M. - 3:45 P.M.

Target Audience: Administrators, Directors, Teachers: New and Experienced,
Training and Technical Staff

Core Competencies: Health, Safety and Nutrition
Professionalism

Presenter(s):

Deborah Russo, Director

Florida Department of Children and Families
1317 Winewood Boulevard, Building 6, 3rd Floor
Tallahassee, FL 32399

Phone: 850-488-4900

FAX: 850-414-7974

E-Mail: Debby.Russo@doh.state.fl.us

56. Inclusion And The Arts Using "Start With The Arts"

Esplanade III

Participants will learn about the curriculum resource guide: Start with the Arts. This user friendly guide contains 54 theme-based lessons linking pre-literacy skills and drama, music, movement, and visual art in compliance with early childhood standards. These resources and arts activities offer parents, teachers, and caregivers arts-based learning tools that emphasize ways that the arts help all children to learn together and succeed.

Program Track: Developmentally Appropriate Curriculum
Special Needs and Inclusion

Target Audience: Administrators, Direct Service Providers, Family Support,
Teachers: New and Experienced

Domain (Standard): Cognitive Development and General Knowledge

Core Competencies: Teaching and Learning Environments and Interactions
Curriculum

Presenter(s):

Marilyn Farber, VSA Florida Professional Development Coordinator

VSA Florida
4202 East Fowler Avenue, EDU105
Tampa, FL 33620

Phone: 813-974-0712

FAX: 813-905-9878

E-Mail: mfarber@usf.edu

57. Let's Make Some Music!

Garrison I-III

(Repeat Session)

Tired of the same old song? This is the presentation for you! A voices and hands-on presentation full of original and old favorite songs and activities with a twist. Come ready to participate and you will leave with a new repertoire of songs and activities that you can use in your classroom with pre-school learners of all abilities.

Program Track: Special Needs and Inclusion
Developmental Appropriate Curriculum

Target Audience: Direct Service Providers, Teachers: New and Experienced

THURSDAY, JULY 21, 2011

2:45 P.M. - 3:45 P.M.

Domain (Standard): Physical Development
Approaches to Learning
Social and Emotional Development
Language, Communication and Emergent Literacy
Cognitive Development and General Knowledge

Core Competencies: Teaching and Learning Environments and Interactions
Curriculum

Presenter(s):

Nancy Lenzen Davis, MT-BC
Board Certified Music Therapist
160 Sam Green Road
Coventry, CT 06238

Phone: 860-888-4631
FAX: 860 742-9366 (not dedicated)
E-Mail: Jayhawk378@aol.com

58. What's A TATS?

Ybor

So, what is a TATS? This interactive session will explore the Priorities, Activities and Products of the Technical Assistance and Training System (TATS). Participants will receive an overview of the TATS project, including Florida's Transition Project, which promotes high quality prekindergarten programs that lead to positive outcomes for children with disabilities and their families. A CD with resources used in the session will be available for participants to take home.

Program Track: Special Needs and Inclusion

Target Audience: Administrators, Direct Service Providers, Directors, Family Support, Teachers: New and Experienced, Training and Technical Staff

Core Competencies: Observing, Documenting, Screening, and Assessing to Support Young Children and Their Families
Professionalism

Presenter(s):

Paula Kendig, TATS Northwest Regional Facilitator
Technical Assistance and Training System (TATS)
2841 Inverness Court
Pensacola, FL 32503

Phone: 850-291-4776
FAX: 850-434-8132
E-Mail: pkendig@gmail.com

Susan Donovan, Ph.D., Project Director
Technical Assistance and Training System (TATS)
University of Central Florida Teaching Academy 403
Orlando, FL 32816-1360

Phone: 407-823-4957
FAX: 407-823-1360
E-Mail: susan.donovan@ucf.edu

Bettianne Ford, Transition Consultant
Technical Assistance and Training System (TATS)
401 SW 42nd Street
Gainesville, FL 32607

Phone: 352-372-2485
E-Mail: bettianne@smilingtiger.com

THURSDAY, JULY 21, 2011

2:45 P.M. - 3:45 P.M.

59. Movin Up! Movin Out! M-o-o-vin All About!

City Center

(located first floor, hotel registration lobby)

Movin Up! Movin Out! M-o-o-vin All About! is a fun filled presentation that explores the benefits of music and movement in early childhood classrooms. Turn off the TV, shut down the computer and phones, and come with us as we explore, create, and express ourselves! The outcome not only benefits your children but also the teachers and staff as well!

Program Track: Child Growth and Development

Target Audience: Teachers: New and Experienced

Domain (Standard): Physical Development
Social and Emotional Development
Cognitive Development and General Knowledge

Core Competencies: Teaching and Learning Environments and Interactions
Curriculum

Presenter(s):

Elisa Schleig, Project Manager
Committee for Academic Excellence
6152 Delancey Station Street
Riverview, FL 33578

Phone: 813-689-6360
E-Mail: elisa.schleig@thecae.org

LaToya Hayes, Senior Coach Mentor
Committee for Academic Excellence
6152 Delancey Station Street
Riverview, FL 33578

Phone: 813-689-6360
E-Mail: latoya.allen@thecae.org

Penny Jenkins, Project Aide
Committee for Academic Excellence
6152 Delancey Station Street
Riverview, FL 33578

Phone: 813-689-6360
E-Mail: gladys.jenkins@thecae.org

CONCURRENT PRESENTATIONS

THURSDAY, JULY 21, 2011

4:00 P.M. - 5:00 P.M.

60. Making Music Matter

Regency II

This highly interactive session will address key developmental concepts through a variety of musical experiences. Participants will move with Elvis, M.C. Hammer, Country and Western, and Disco artists while learning fun ways to incorporate early learning standards into their preschool classrooms.

Program Track: Developmentally Appropriate Curriculum

Target Audience: Directors, Teachers: New and Experienced

Domain (Standard): Physical Development
Cognitive Development and General Knowledge

Core Competencies: Teaching and Learning Environments and Interactions
Curriculum

Presenter(s):

Donna Whittaker, *Infant Toddler Specialist*
Early Learning Coalition of Northwest Florida
703 West 15th Street, Suite A
Panama City, FL 32401

Phone: 850-866-3767
FAX: 850-747-5450
E-Mail: donna.whittaker@elcnwf.org

61. Achieving Cohesiveness With Ease

Regency V

Explore new ways to maximize the involvement of your staff, increase potential, and break down barriers. This interactive presentation allows participants to learn by doing so that they experience and understand the benefits of working together toward the future. This adventure-based presentation provides examples in action of how we can positively influence and help our staff move forward. In a world where change is constant, everyone needs to learn to work together, and what better way than to have a chance to play together first in a workshop.

Program Track: Management and Leadership

Target Audience: Administrators, Directors

Core Competencies: Teaching and Learning Environments and Interactions
Curriculum

Presenter(s):

Cynthia Krosky, *CSP, LCSW*
Achieving Corporate Excellence, Inc.
Post Office Box 651119
Vero Beach, FL 32965-1119

Phone: 772-461-8313
E-Mail: achieve@achievingcorporateexcellence.com

THURSDAY, JULY 21, 2011

4:00 P.M. - 5:00 P.M.

**62. Voluntary Prekindergarten Professional Development
And Teacher Resources**

Regency VI

Participants will receive information on the wide selection of resources and trainings available to Voluntary Prekindergarten (VPK) and other early childhood providers. Areas of interest range from the new Florida VPK Assessment, the VPK Teacher Toolkit, an online resource, and VPK Standards Trainings. Participants will also receive an introduction to the Training Management System (TMS), the portal used to access and register for many of the VPK professional development opportunities. There will be a question and answer period at the close of the presentation.

Program Track: Management and Leadership

Target Audience: Administrators, Directors, Teachers: New and Experienced

Core Competencies: Teaching and Learning Environments and Interactions
Professionalism

Presenter(s):

Tara Huls, Ph.D., Educational Policy Consultant

Florida Department of Education, Office of Early Learning
325 West Gaines Street, Suite 514
Tallahassee, FL 32399

Phone: 850-245-5037
FAX: 850-245-5105
E-Mail: tara.huls@fldoe.org

Melinda Webster, Director, Program Standards and Professional Development

Florida Department of Education, Office of Early Learning
325 West Gaines Street, Suite 514
Tallahassee, FL 32399

Phone: 850-245-7808
FAX: 850-245-5105
E-Mail: melinda.webster@fldoe.org

**63. If I Can't Picture It, I Can't Understand It: The Effective
Use Of Visual Supports**

Regency VII

For many children with communication challenges, the use of visually supported communication is more effective and efficient than just talking to them. Visual tools assist children in processing language, organizing their thinking, remembering information, and many other skills necessary to participate effectively. Participants will learn how to use visual strategies to enhance children's learning of effective communication, appropriate social interactions, and support positive behavior. Strategies will include sharing materials and how to implement the use of visual supports. Samples and examples will be shared. Audience participation will be encouraged. Handouts include resources.

Program Track: Mental Health/Managing Behaviors

Target Audience: Teachers: New and Experienced

Domain (Standard): Language, Communication and Emergent Literacy

Core Competencies: Child Development and Learning
Teaching and Learning Environments and Interactions

THURSDAY, JULY 21, 2011

4:00 P.M. - 5:00 P.M.

Presenter(s):

Desiree Bohorques, *Inclusion Specialist*

Early Learning Coalition of Miami Dade/Monroe County
2555 Ponce de Leon Boulevard, Suite 500
Coral Gables, FL 33134

Phone: 786-303-6805
FAX: 305-447-1608
E-Mail: dbohорques@elcndm.org

Sandra Ampudia, *Inclusion Specialist*

Early Learning Coalition of Miami Dade/Monroe County
2555 Ponce de Leon Boulevard, Suite 500
Coral Gables, FL 33134

Phone: 786-942-2546
FAX: 305-447-1608
E-Mail: sampudia@elcndm.org

64. A Guide To The Florida Child Care Staff Credential

Buccaneer A

This presentation will provide early childhood practitioners with the knowledge of how to receive a Florida child care staff credential. The credential unit staff will present information pertaining to the qualifications needed to earn the staff credential. This will be followed by the application process, and examples of the necessary documentation required for receipt of the application will also be provided. The staff will guide participants through completing the application in its entirety; technical assistance will be available, followed by questions and answers. Important contact information will also be provided.

Program Track: Management and Leadership

Target Audience: Administrators, Direct Service Providers, Directors,
Teachers: New and Experienced

Core Competencies: Professionalism

Presenter(s):

Prisha Malone, *Credential Unit Supervisor*

Children's Forum
2807 Remington Green Circle
Tallahassee, FL 32308

Phone: 850-681-7002
FAX: 850-922-4459
E-Mail: pmalone@thechildrensforum.com

Elizabeth Burns, *Credential Unit Specialist*

Children's Forum
2807 Remington Green Circle
Tallahassee, FL 32308

Phone: 850-681-7002
FAX: 850-922-4459
E-Mail: eburns@thechildrensforum.com

Christian Winterbottom, *Director of Child Care Evaluation Services*

Children's Forum
2807 Remington Green Circle
Tallahassee, FL 32308

Phone: 850-681-7002
FAX: 888-596-9513
E-Mail: cwinterbottom@thechildrensforum.com

65. Creating Confident Writers

Buccaneer B

The first experiences children have with writing are an essential step in developing literacy. Research supports the practice of providing motivating and engaging writing opportunities to support children's growth in letter knowledge, phonological awareness, and oral language. In this interactive session, presenters will demonstrate developmentally appropriate writing activities that foster emergent writing in preschool children. Participants will discover tips that will help young children become writers for life.

THURSDAY, JULY 21, 2011

4:00 P.M. - 5:00 P.M.

Program Track: Developmentally Appropriate Curriculum
Target Audience: Teachers: New
Domain (Standard): Language, Communication and Emergent Literacy
Core Competencies: Teaching and Learning Environments and Interactions Curriculum

Presenter(s):

Betty Raimondo, *Early Literacy Teacher*
Nemours BrightStart!
10140 Centurion Parkway North
Jacksonville, FL 32256

Phone: 904-697-5106
E-Mail: braimond@nemours.org

66. Early Learning Partners Initiative-What's In It for Children? Buccaneer C

This presentation will provide an overview of the projects within the Early Learning Partners Initiative, specifically Child Progress, School Readiness Curriculum, and Professional Development, and their impact on ensuring children enter kindergarten ready to learn. The session will outline specific components of the projects and outline their connection to providing the necessary elements for readiness.

Program Track: Screenings/Assessments/Evaluations
Target Audience: Administrators, Direct Service Providers, Directors, Family Support, Teachers: New and Experienced, Training and Technical Staff
Core Competencies: Professionalism

Presenter(s):

Noelle Bee, *Statewide Child Progress Coordinator*
Agency for Workforce Innovation, Office of Early Learning
107 East Madison Street, MSC #140
Tallahassee, FL 32399

Phone: 850-921-3398
FAX: 850-921-3188
E-Mail: Noelle.Bee@flaawi.com

67. Early Recognition, Early Success: Overview Of Early Steps Buccaneer D

The purpose of this session is to present an overview of the Early Steps program to childcare providers who want to know more about Florida's early intervention program. The focus will be child find activities including eligibility, referrals, screenings, and public awareness. Come join us as we discuss the Central Directory and how it is a very valuable resource right at our "fingertips."

Program Track: Special Needs and Inclusion

THURSDAY, JULY 21, 2011

4:00 P.M. - 5:00 P.M.

Target Audience: Administrators, Direct Service Providers, Directors, Family Support, Teachers: New and Experienced, Training and Technical Staff

Core Competencies: Observing, Documenting, Screening, and Assessing to Support Young Children and Their Families

Presenter(s):

Haylie Smith, *Early Steps State Office*

Children's Medical Services

Florida Department of Health

4052 Bald Cypress Way, BIN #A06

Tallahassee, FL 32399-1707

Phone: 850-245-4444, Ext. 2267

Fax: 850-921-8138

Email: Haylie.Smith@doh.state.fl.us

Lou Ann Long, *Director, Disabilities & Special Health Care Needs Unit*

Children's Forum

2807 Remington Green Circle

Tallahassee, FL 32308

Phone: 850-487-6301 or 1-800-654-4440

FAX: 850-681-9816

E-Mail: lalong@centraldirectory.org

68. Parents As Teachers - Ahead Of The Curve On Evidence-Based Home Visiting

Esplanade I

This presentation will focus on the recent changes to the home visiting parent education model, Parents as Teachers. A new affiliation system and a new curriculum were launched in January of 2011. Together these innovative updates to an already high quality model ensure solid outcomes for young children.

Program Track: Family Involvement and Support

Target Audience: Administrators, Direct Service Providers, Family Support, Training and Technical Staff

Core Competencies: Building Family and Community Relationships

Presenter(s):

Ruth Elswood, *Ph.D., State Leader*

Parents as Teachers

Florida Parental Information and Resource Center

University of South Florida

Tampa, FL 33613

Phone: 813-396-9137

FAX: 813-396-9925

E-Mail: elswood@usf.edu

THURSDAY, JULY 21, 2011

4:00 P.M. - 5:00 P.M.

**69. Identifying And Nurturing Potential In Young Children
With Dual Languages And Dual Exceptionalities**

Esplanade II

The purpose of this presentation is to share information about a pilot preschool teacher training project implemented in January of 2011, in South Florida. The purpose of the project was to help preschool teachers to identify children in their classroom whose home language is not English, who have special needs, and who are demonstrating potential giftedness. Once these children were identified, group and individual support was provided to the teachers, in a variety of different formats, to help the teachers and parents support the children's potential.

Program Track: Special Needs and Inclusion

Target Audience: Administrators, Directors, Teachers: New and Experienced

Core Competencies: Child Development and Learning
Teaching and Learning Environments and Interactions

Presenter(s):

Dana Fredebaugh, Ph.D., Program Professor
Nova Southeastern University
1750 NE 167 Street
North Miami Beach, FL 33162

Phone: 954-262-8632
FAX: 954-262-3826
E-Mail: danaf@nova.edu

**70. Islands Of Excellence - Do And Learn Or Sit And Get?
Professional Development To Enhance Quality**

Esplanade III

Professional Development re-envisioned: ideas for offering professional development in meaningful and unique ways. A discussion of group projects that allow for independent study through which a large number of individuals may obtain shared knowledge. Practical ways to do professional development that allow for expertise to be shared among practitioners, to support one another in parallel learning, and to earn needed CEUs in a coordinated way: reading shared literature, using the same classroom resources, and using feedback from each project to achieve overarching learning outcomes.

Program Track: Management and Leadership

Target Audience: Administrators

Core Competencies: Teaching and Learning Environments and Interactions
Professionalism

THURSDAY, JULY 21, 2011

4:00 P.M. - 5:00 P.M.

Presenter(s):

Gayla Thompson, *Associate Director of Program Services*

Early Learning Coalition of Southwest Florida
5256 Summerlin Commons Way, #201
Ft. Myers, FL 33907

Phone: 239-210-6868

FAX: 239-267-4109

E-Mail: gayla.thompson@elcofswfl.org

71. One Book Across The Curriculum

Garrison I-III

Take story books beyond circle time and across the curriculum. Learn how to link literacy across all domains of the curriculum using the Florida State Standards. Learn ways you can create a classroom where the child becomes part of the story book.

Program Track: Developmentally Appropriate Curriculum

Target Audience: Teachers: New and Experienced

Domain (Standard): Physical Development
Approaches to Learning
Social and Emotional Development
Language, Communication and Emergent Literacy
Cognitive Development and General Knowledge

Core Competencies: Teaching and Learning Environments and Interactions
Curriculum

Presenter(s):

Brenda Engstrom, *Para-Professional Head Start Teacher*

School District of Lee County Early Head Start
3650 Michigan Avenue
Fort Myers, FL 33916

Phone: 239-332-2512

FAX: 239-334-2629

E-Mail: brendase@leeschools.net

72. Family Providers Focus On Literacy

Ybor

The Early Learning Coalitions of Polk, Manatee, and Sarasota Counties were awarded a literacy grant in the summer of 2010. The grant, awarded through the Helios Education Foundation, provides intensive onsite coaching of licensed family child care homes to improve the understanding, skill level, and teaching practices that promote emergent literacy. Discussion and training will center around how to enhance and promote the skill building of language and literacy for family child care home providers and the children and families enrolled in their programs.

Program Track: Child Growth and Development

THURSDAY, JULY 21, 2011

4:00 P.M. - 5:00 P.M.

Target Audience: Training and Technical Staff
Domain (Standard): Language, Communication and Emergent Literacy
Core Competencies: Teaching and Learning Environments and Interactions
Curriculum

Presenter(s):

Shelia B. Chambers, Program Supervisor

Early Learning Coalition of Polk County
1765 North Broadway Avenue
Bartow, FL 33830

Phone: 863-733-9064, ext. 215
FAX: 863-733-9081
E-Mail: sheliachambers@elcpolk.org

Barbara Huffstutler, Helios Quality Specialist

Early Learning Coalition of Polk County
1765 North Broadway Avenue
Bartow, FL 33830

Phone: 863-733-9064, ext. 215
FAX: 863-733-9081
E-Mail: barbarahuffstutler@elcpolk.org

Marjorie Fondacaro, Early Childhood Literacy Specialist

Early Learning Coalition of Sarasota County
1750 17th Street, Building L
Sarasota, FL 34234

Phone: 941-954-4830, ext. 225
FAX: 941-954-4831
E-Mail: mfondacaro@earlylearningcoalitionsarasota.org

Tina DiPietrantonio, Program Quality Specialist

Early Learning Coalition of Manatee County, Inc.
1750 17th Street, Building L
Bradenton, Florida 34205

Phone: 757-2900
FAX: 941-757-2915
E-Mail: tdi Pietrantonio@elc-manatee.org

5:00 P.M. - 10:00 P.M. FREE SHUTTLE TO WESTSHORE PLAZA MALL

Westshore Plaza, an enclosed shopping mall, featuring 115 stores including Saks Fifth Avenue, Lindt & Sprungli, Ann Taylor, and restaurants including Maggiano's Little Italy and The Palm Steakhouse. The shuttle bus stop is located directly in front of the hotel registration lobby.

8:00 P.M. - 11:00 P.M. "COME ALIVE WITH MUSIC" PARTY Regency II

An evening of music and fun. Co-sponsored by Lakeshore Learning Materials. Solid Gold Entertainment will provide a wide variety of musical entertainment from the latest and hottest dance floor hits to line dancing and classics from the past...so put on your dancing shoes and come boogie with us. Snacks and soft drinks provided. Cash bar will be available.

CONCURRENT PRESENTATIONS

FRIDAY, JULY 22, 2011

8:30 A.M. - 10:00 A.M.

73. **Making The Body-Brain Connection In Teaching And Learning** Regency II

What's the latest information on how the young brain works? What does the body have to do with learning? Where and how are memories stored? These are just a few questions that are addressed in this informative and interactive presentation.

Program Track: Child Growth and Development

Target Audience: Administrators, Directors, Teachers: New and Experienced, Training and Technical Staff

Domain (Standard): Physical Development
Approaches to Learning
Social and Emotional Development
Language, Communication and Emergent Literacy
Cognitive Development and General Knowledge

Core Competencies: Child Development and Learning
Teaching and Learning Environments and Interactions

Presenter(s):

Keith Pentz, *National Education Advisor*
4129 Via Piedra Circle
Sarasota, FL 34233

Phone: 941-320-2315
E-Mail: KLPentz@aol.com



Keith L. Pentz has been in the field of education for over 25 years. Pentz began his career by working in childcare with infants and toddlers. Later, he taught elementary students as well as Kindergarten. Pentz spent the remainder of his classroom time teaching Prekindergarten and working with specifically with low socio-economic families and inclusion students. Following his experiences in the classroom, Keith moved on to teach at the University of Central Florida in Orlando, Florida and he also was a Profession of Early Childhood Education at Gordon College in Wenham, Massachusetts. Pentz is a National Education-Curriculum Specialist for Kaplan Early Learning Company.

FRIDAY, JULY 22, 2011

8:30 A.M. - 10:00 A.M.

74. More Than Just Talk: Early Communication And Play

Regency V

Children at a very early age develop strategies to communicate their needs. These are called “pre linguistic indicators,” and they are the precursors of later language development. When developmental delays in communication are not identified, children may not receive services that are vital for language development. Language and communication affects children socially, emotionally, and academically. This presentation will give information on what pre linguistic indicators are seen in children as early as nine months of age. It will also provide strategies to use to encourage communication through play and daily routines. Discussion will also include the importance of emotional regulation and it’s relationship to social communication.

Program Track: Special Needs and Inclusion
Child Growth and Development

Target Audience: Administrators, Direct Service Providers, Directors,
Teachers: New and Experienced, Training and Technical
Staff

Domain (Standard): Language, Communication and Emergent Literacy

Core Competencies: Child Development and Learning

Presenter(s):

Laura L. Stannard, Ph.D., Kindergarten and Pre-Kindergarten Teacher/Consultant
Creative Center for Childhood Research & Training Phone: 850-386-1450
2746 West Tharpe Street FAX: 850-422-1283
Tallahassee, FL 32303 E-Mail: ccprt@comcast.net

**75. Overview Of The Early Learning And Development Standards
In Florida - Including The New Standards For Four-Year-Olds**

Regency VI

The Florida Department of Education's Office of Early Learning and the Agency for Workforce Innovation's Office of Early Learning have collaborated to develop *Florida Early Learning and Developmental Standards for Four-Year-Olds*. This presentation will overview the Standards for children ages birth to five years old. Come and receive an introduction to the new standards. There will be a question and answer period following the presentation.

Program Track: Developmentally Appropriate Curriculum

Target Audience: Administrators, Directors, Teachers: New and Experienced

FRIDAY, JULY 22, 2011

8:30 A.M. - 10:00 A.M.

Core Competencies: Child Development and Learning
Curriculum

Presenter(s):

Staff from Florida Department of Education, Office of Early Learning
Florida Department of Education, Office of Early Learning
325 West Gaines Street, Suite 514
Tallahassee, FL 32399

Staff from Agency for Workforce Innovation, Office of Early Learning
Agency for Workforce Innovation, Office of Early Learning
107 East Madison Street, MSC 140
Tallahassee, FL 32399

76. Rocks In My Head Regency VII
(*Session Repeated, #87*)

Whether you are a rock collector, a novice, have a pet rock, or have not really given rocks much thought, come and learn more about the fascinating world of rocks and minerals. Come and explore the many facets of rocks and minerals and how they can be used to enhance various areas of the curriculum. You will leave this highly interactive presentation with ideas and materials to immediately begin implementing a rock curriculum in your classroom. Discover, learn, and have fun!

Program Track: Developmentally Appropriate Curriculum

Target Audience: Administrators, Directors, Teachers: New and Experienced

Domain (Standard): Cognitive Development and General Knowledge

Core Competencies: Teaching and Learning Environments and Interactions
Curriculum

Presenter(s):

Lina Lloyd, Resource Specialist
Early Learning Coalition of St. Lucie County
804 South 6th Street
Fort Pierce, FL 34982

Phone: 772-595-6424, ext. 116
FAX: 772-595-6081
E-Mail: lloyda01@elcslc.org

FRIDAY, JULY 22, 2011

8:30 A.M. - 10:00 A.M.

77. No Worry! Where To Call If You Think Your Child May Need Intervention

Buccaneer A

Most early care and education providers have a good understanding of developmental milestones and recognize children who do not seem to be meeting those expectations. Parents may express concerns about their child's development, but do not know where to turn for help? Where do we begin? Where do we refer and discuss concerns? What should and shouldn't happen if the child meets eligibility criteria for Individuals with Disabilities Improvement Act (IDEA) services?

Program Track: Special Needs and Inclusion

Target Audience: Administrators, Direct Service Providers, Directors, Teachers: New and Experienced, Training and Technical Staff

Core Competencies: Observing, Documenting, Screening, and Assessing to Support Young Children and Their Families

Presenter(s):

Lou Ann Long, *Director, Disabilities & Special Health Care Needs Unit*

Children's Forum

Phone: 850-487-6301 or 1-800-654-4440

2807 Remington Green Circle

FAX: 850-681-9816

Tallahassee, FL 32308

E-Mail: ialong@centraldirectory.org

78. Can We Teach Children With Challenging Behavior? YES!

Buccaneer B

Challenging behavior communicates a message. Let's look closely at the function of the behavior and the possible triggers. Through positive behavior supports, we can eliminate or modify the challenging behavior. Often the trigger is our classroom or our responses. Pictures and scripted stories are powerful motivators/instructors for children. Relationships are crucial to the equation. Challenging behavior continues as long as it works; let's create plans to make it ineffective. If we focus on teaching a new skill, we can provide this child with a new life skill! That is a powerful gift.

Program Track: Mental Health/Managing Behaviors

Target Audience: Direct Service Providers, Directors, Teachers: New and Experienced, Training and Technical Staff

Domain (Standard): Physical Development
Social and Emotional Development

FRIDAY, JULY 22, 2011

8:30 A.M. - 10:00 A.M.

Core Competencies: Child Development and Learning
Curriculum

Presenter(s):

Brett Engisch, P.I.E.C.E. Project Manager

Early Learning Coalition of Pinellas County, Inc.
5735 Rio Visat Drive
Clearwater, FL 33760

Phone: 727-548-1439, ext .247
FAX: 727-548-1509
E-Mail: bengisch@elcpinellas.net

79. Professional Development Pathways For Afterschool Practitioners

Buccaneer C

Florida has launched an exciting initiative in the early childhood field called Florida Steps to Success: Career Pathways for Early Childhood Practitioners. Concurrently, efforts are underway to create a parallel pathway for afterschool practitioners. Come to this session to hear an update on the exciting plans for the afterschool field.

Program Track: Management and Leadership
School-Age Child Care

Target Audience: Administrators, Directors, Teachers: New and Experienced,
Training and Technical Staff

Core Competencies: Professionalism

Presenter(s):

Larry Pintacuda, Project Director

Florida Afterschool Network
216 South Monroe Street
Tallahassee, FL 32301

Phone: 850-222-1340
E-Mail: lpintacuda@floridacsc.org

Phyllis Kalifeh, President/CEO

Children's Forum, Inc.
2807 Remington Green Circle
Tallahassee, FL 32308

Phone: 850-681-7002
FAX: 850-681-9816
E-Mail: pkalifeh@thechildrensforum.com

Jennifer Faber, State School-Age Services Coordinator

Agency for Workforce Innovation, Office of Early Learning
6973 Kimberly Terrace
Ft. Myers, FL 33919

Phone: 239-433-6597
FAX: 239-433-6603
E-Mail: Jennifer.Faber@flaawi.com

FRIDAY, JULY 22, 2011

8:30 A.M. - 10:00 A.M.

80. Yes Virginia, There Are No Gender Differences In Play Behaviors Of Young Children Of Immigrant Seasonal Farm Workers From Mexico Living In The United States

Buccaneer D

This presentation explores research in gender differences in play of young children of immigrant seasonal farm workers from Mexico who are currently living in the United States. The purpose of this research is to explore gender differences in play behaviors, in different settings, of young children of immigrant seasonal farm workers from Mexico. Specifically, the research is aimed to explore gender differences in: a. language preferences during play in school and home environments; b. social groupings during play in school and home environments; and c. cognitive tasks used during play in school and home environments. The results of the research revealed that the children exhibited no statistically significant gender differences in their play activities in any of the three settings. The observed gender-neutral play is unexpected and underscores the importance of qualitative analysis of the cultural context of children's play using an ecological framework. The results will be discussed along with implications for professional development of teachers.

Program Track: Child Growth and Development

Target Audience: Administrators, Directors, Teachers: New and Experienced

Domain (Standard): Approaches to Learning
Social and Emotional Development

Core Competencies: Child Development and Learning
Teaching and Learning Environments and Interactions

Presenter(s):

Smita Mathur, Ph.D., Assistant Professor, Division of Education

University of South Florida Polytechnic

3433 Winter Lake Road

Lakeland, FL 32803

Phone: 863-667-7087

E-Mail: smathur@poly.usf.edu

81. Managing A Multigenerational Workforce

Esplanade I

The current workplace has four generations working side-by-side. Each generation has been shaped by different experiences, which influence their traits in the workplace. This presentation will examine the distinctive traits of each of the generations. After examining the individual characteristics of the generations, the presentation will include a description of the impact of these traits on co-workers and managers. The presentation will conclude with a brainstorming session on how to utilize the strengths of each generation for a harmonious workplace.

FRIDAY, JULY 22, 2011

8:30 A.M. - 10:00 A.M.

Program Track: Management and Leadership

Target Audience: Administrators, Directors, Training and Technical Staff

Core Competencies: Professionalism

Presenter(s):

Tara Orłowski, *Early Childhood Program Director/Institutional Effectiveness*

North Florida Community College

325 NW Turner Davis Drive, Building 5, Room 101A

Madison, FL 32340

Phone: 850-973-1789

FAX: 850-973-1684

E-Mail: orłowskit@nfcc.edu

82. Talk Isn't Cheap...It's Priceless!

Esplanade II

This interactive presentation will detail the importance of conversation with young children....talking WITH children, not "at" or "to" them. The significance of both "word" knowledge and "world" knowledge (Washington, 2006) will be discussed in-depth. We'll review the landmark research of Hart & Risley (1995) via interactive discussion, and dialogue on how to implement conversation in the early childhood environment.

Program Track: Developmentally Appropriate Curriculum

Target Audience: Teachers: New and Experienced

Domain (Standard): Language, Communication and Emergent Literacy

Core Competencies: Child Development and Learning
Teaching and Learning Environments and Interactions

Presenter(s):

Heidi Maier, *Ph.D., Associate Professor, Early Childhood Education*

College of Central Florida

College of Central Florida, Teacher Education

Ocala, FL 34476

Phone: 352-433-6838

FAX: 352-291-4464

E-Mail: maierh@cf.edu

FRIDAY, JULY 22, 2011

8:30 A.M. - 10:00 A.M.

83. Using Observation-Based Assessment For Children Birth Through Kindergarten: The Palette Of Early Childhood Development And Experiences

Esplanade III

This presentation describes a seamless, efficient approach to ongoing, observation-based assessment for all children birth through kindergarten. During the session, we will examine ways that teachers can intentionally gather assessment information about children's development, as well as their content learning. Gathering this data in authentic contexts helps teachers ensure they are assessing children's abilities accurately, especially children who may be at risk for future school success.

Program Track: Screenings/Assessments/Evaluations

Target Audience: Administrators, Teachers: New and Experienced

Core Competencies: Observing, Documenting, Screening, and Assessing to Support Young Children and Their Families

Presenter(s):

Sally Edwards

Staff Trainer

7101 Wisconsin Avenue, Suite 700
Bethesda, MD 20814

Phone: 301-634-0818

FAX: 301-657-0250

E-Mail: litalk@teachingstrategies.com

84. Dealing With Difficult Children

Garrison I-III

Do you cringe every time Johnny walks in the room, knowing his behavior will ruin your day? Find out how teaching cooperation and problem solving skills can help change behavior. Your day can be less stressful, and we will discuss how to get children to cooperate with you and to learn how to handle their own disputes with others in a socially acceptable manner. Children will gain the techniques to be social problem solvers.

Program Track: Mental Health/Managing Behaviors

Target Audience: Direct Service Providers, Directors, Teachers: New and Experienced

Domain (Standard): Physical Development
Approaches to Learning
Social and Emotional Development

Core Competencies: Child Development and Learning
Teaching and Learning Environments and Interactions

FRIDAY, JULY 22, 2011

8:30 A.M. - 10:00 A.M.

Presenter(s):

Suzanne Gellens, *Executive Director*

Florida Association for the Education of Young Children
3026 West Main Street
Tampa, FL 33607

Phone: 813-878-9973

FAX: 813-878-9978

E-Mail: sgellens@flaeyc.org

CONCURRENT PRESENTATIONS

FRIDAY, JULY 22, 2011

10:15 A.M. - 11:45 A.M.

85. Techniques For Working With Difficult People

Regency V

Everyone working in the field of Child Care Resource and Referral (CCR&R) has had to deal with difficult, angry, or rude people, sometimes on a daily basis. Families calling CCR&R are frequently in the midst of a crisis situation and may be very upset or frustrated by the time they call. Regardless of what the reason may be for a person's anger and frustration, this experience can be very stressful for an intake specialist making your job very difficult or even intolerable. This interactive session will provide useful techniques and allow you time to share tips and advice that can be used in a variety of difficult people situations.

Program Track: Family Involvement and Support

Target Audience: Family Support

Core Competencies: Building Family and Community Relationships
Professionalism

Presenter(s):

Marilyn Hibbard, *State CCR&R Network Administrator*

Agency for Workforce Innovation, Office of Early Learning
107 East Madison Street, MSC #140
Tallahassee, FL 32399

Phone: 850-617-5606

FAX: 850-921-3188

E-Mail: marilyn.hibbard@flaawi.com

Gerie Nasche, *Director of CCR&R Family Support Services*

Agency for Workforce Innovation, Office of Early Learning
107 East Madison Street, MSC #140
Tallahassee, FL 32399

Phone: 850-921-3199

FAX: 850-921-3188

E-Mail: gerie.nasche@flaawi.com

86. "How Do I Make Positive Behavior Support Work For ME?"

Regency VI

This presentation will highlight common barriers to full implementation of Positive Behavior Support in a classroom and discuss how to overcome barriers, the importance of relationship building, and ways to not only celebrate success, but guarantee its continuity.

Program Track: Mental Health/Managing Behaviors

Target Audience: Directors, Teachers: New and Experienced

Domain (Standard): Social and Emotional Development

FRIDAY, JULY 22, 2011

10:15 A.M. - 11:45 A.M.

Core Competencies: Child Development and Learning
Teaching and Learning Environments and Interactions

Presenter(s):

Dottie Stone, Child Development and Inclusion Coordinator
Early Learning Coalition of Florida's Gateway, Inc.
1104 SW Main Boulevard
Lake City, FL 32025

Phone: 386-961-0145
FAX: 386-628-9345
E-Mail: dstone@elc-fg.org

Charis Stone, Lead Teacher
Happy House, Inc.
Post Office Box 1282
Lake City, FL 32056

Phone: 386-752-4736
FAX: 386-752-0466
E-Mail: hhccsw@bellsouth.net

87. Rocks In My Head
(Repeat Session)

Regency VII

Whether you are a rock collector, a novice, have a pet rock, or have not really given rocks much thought, come and learn more about the fascinating world of rocks and minerals. Come and explore the many facets of rocks and minerals and how they can be used to enhance various areas of the curriculum. You will leave this highly interactive presentation with ideas and materials to immediately begin implementing a rock curriculum in your classroom. Discover, learn, and have fun!

Program Track: Developmentally Appropriate Curriculum

Target Audience: Administrators, Directors, Teachers: New and Experienced

Domain (Standard): Cognitive Development and General Knowledge

Core Competencies: Teaching and Learning Environments and Interactions
Curriculum

Presenter(s):

Lina Lloyd, Resource Specialist
Early Learning Coalition of St. Lucie County
804 South 6th Street
Fort Pierce, FL 34982

Phone: 772-595-6424, ext. 116
FAX: 772-595-6081
E-Mail: lloyda01@elcslc.org

FRIDAY, JULY 22, 2011

10:15 A.M. - 11:45 A.M.

**88. Quality Rating Improvement Systems (QRIS) - The Vision...
The Journey To A Statewide System**

Buccaneer A

Quality Rating Improvement Systems are a national solution to a nation problem, and Florida is no exception. Join QRIS administrators from Miami and Duval counties in an interactive discussion of their respective systems, the QRIS Multicounty Collaboration Project and current initiatives that together lay the foundation for envisioning a statewide system.

Program Track: Management and Leadership

Target Audience: Administrators, Directors, Training and Technical Staff

Core Competencies: Professionalism

Presenter(s):

Pamela Hollingsworth, *Professional Title: Director Quality Counts*

Early Learning Coalition Miami-Dade/Monroe

2555 Ponce de Leon Boulevard

Coral Gables, FL 33134

Phone: 786-301-9926

Email: phollingsworth@elcmdm.org

Padma Rajan, *Director of Program Accountability & Quality*

Early Learning Coalition of Duval

8301 Cypress Plaza Drive

Jacksonville, FL 32256

Phone: 904-208-2040 ext. 204

Email: prajan@elcofduval.org

89. Play The Domain Way: Totally Terrific Tray Play

Buccaneer B

This fun and interactive presentation will teach you how to address the Florida School Readiness Performance Standard domains in your daily lesson plans through tray play activities with children ages two through five. You will receive handouts and cost-effective ideas for organizing lesson plans, materials, and activities in order to help children make independent choices for tray play. You will learn how to turn trash into tray play treasures through simple yet effective recycling ideas.

Program Track: Developmentally Appropriate Curriculum

Target Audience: Directors, Teachers: New and Experienced

Domain (Standard): Approaches to Learning
Cognitive Development and General Knowledge

FRIDAY, JULY 22, 2011

10:15 A.M. - 11:45 A.M.

Core Competencies: Teaching and Learning Environments and Interactions
Curriculum

Presenter(s):

Janie W. Richardson, Program Specialist

Early Learning Coalition of Florida's Gateway, Inc.
1104 SW Main Boulevard
Lake City, FL 32025

Phone: 386-961-0128
FAX: 386-628-9328
E-Mail: jrichardson@elc-fg.org

**90. Back To Basics: Meeting Primary Needs To Foster
Cooperation And Connection With ALL Children**

Buccaneer C

In our fast-paced society, we are all too often consumed with the need for children to use the latest technology, pass "that" State exam, but are forgetful of what is most important. Developmental psychology reminds us that children must have their physiological and safety needs met before any learning can take place. This hands-on, interactive session will provide participants with the essential skills needed to bring their focus back to the basic needs of students. Participants will learn how to utilize a variety of resources and will receive tools to provide all children with a safe and positive learning environment.

Program Track: Mental Health/Managing Behaviors

Target Audience: Directors, Family Support, Teachers: New and Experienced

Domain (Standard): Physical Development
Approaches to Learning
Social and Emotional Development

Core Competencies: Child Development and Learning
Teaching and Learning Environments and Interactions

Presenter(s):

Suzette Woten, Licensed Clinical Social Worker

Winter Haven Hospital Center for Behavioral Health
1204 Thompson Circle NW
Winter Haven, FL 33881-2304

Phone: 863-224-7573
FAX: 863-291-3611
E-Mail: suzettew63@yahoo.com

Polly Beebe, Teacher

Orange County Public School

FRIDAY, JULY 22, 2011

10:15 A.M. - 11:45 A.M.

**91. Linking Florida's Career Pathway And Registry:
What's In It For You!**

Buccaneer D

Much work has been completed to outline the options in Florida's early care and education career pathways and to plan and build a registry to house professional development information for the field. Come to this session to see how these efforts are connected and what resources and supports are being developed that may be helpful to you.

Program Track: Management and Leadership

Target Audience: Administrators, Direct Service Providers, Directors,
Teachers: New and Experienced, Training and Technical
Staff

Core Competencies: Professionalism

Presenter(s):

Edwiygh Franck, Registry Coordinator

Palm Beach State College Institute of Excellence
812 Fern Street
West Palm Beach, FL 33401

Phone: 561-868-3664

FAX: 561-868-7042

E-Mail: francke@palmbeachstate.edu

Alisa Ghazvini, Ph.D.

Early Childhood Consultant
1462 Mitchell Avenue
Tallahassee, FL 32303

Phone: 850-545-7716

FAX: 850-893-0683

E-Mail: aghazvini@hotmail.com

92. Birth-5: Addressing The Needs Of The Youngest Refugees

Esplanade I

In 2009-10 more than 27,000 refugees resettled in Florida. Approximately 6% were children ages birth-5. This presentation will define refugee, parolee, and asylee, and describe the very specific needs of refugee families and their young children. A brief discussion will address child well-being, acculturation, and developmental milestones. The last segment will focus on connecting the family within the community and the role of child care, including strategies to engage families. Excellent hands-on activities, handouts and resources.

Program Track: Cultural Diversity/Multicultural Education

Target Audience: Administrators, Training and Technical Staff

Core Competencies: Child Development and Learning
Teaching and Learning Environments and Interactions

FRIDAY, JULY 22, 2011

10:15 A.M. - 11:45 A.M.

Presenter(s):

Bethany Sands, *Inclusion/Assessment Program Director*

Early Learning Coalition of Miami-Dade/Monroe
2555 Ponce de Leon Boulevard, Suite 500
Coral Gables, FL 33134

Phone: 305-803-1272
FAX: 305-447-1608
E-Mail: bsands@elcmdm.org

Stephanie Scott, *Senior Research Assistant*

University of Miami
1601 NW 12 Avenue
Miami, FL 33136

Phone: 305-243-6624
FAX: 305-243-3410
E-Mail: sscott2@med.miami.edu

93. Moving Florida Forward: Creating A Collaborative System Of Care For Children And Families

Esplanade II

We are all familiar with the saying "it takes a village," but in reality these days it takes the entire state! With a state as big and diverse as Florida, it is incredibly important that the many partners and stakeholders that work with and on behalf of children and families are collaborative. Even in the midst of a slow economic recovery, there are resources and system development activities that can enhance our collective efforts to ensure our children are healthy, well cared for, learned, and prepared for a successful future. In the last few years, many experts in child development and services have developed a framework with a comprehensive and coordinated vision for creating a system of care. In this session, participants will learn about Florida's Framework for Early Childhood Development and Well-being, current initiatives that align to the Framework, as well as potential future efforts that will benefit our children and families. The session will highlight the work of the Florida Children's Services Council, state agencies, and organizations, as well as local organizations that are working together to develop a comprehensive system of care for Florida.

Program Track: Management and Leadership

Target Audience: Administrators, Directors, Teachers: New and Experienced, Training and Technical Staff

Core Competencies: Professionalism

Brittany Olivieri Birken, *Ph.D., Executive Director*

Florida Children's Services Council
216 South Monroe Street
Tallahassee, FL 32301

Phone: 850-402-5437, ext. 1
Fax: 850-942-5437
Email: bbirken@floridacsc.org

FRIDAY, JULY 22, 2011

10:15 A.M. - 11:45 A.M.

94. Yesology: Sending The Y.E.S. (You're Extra Special) Message Esplanade III

Motivate yourself and others! Motivation starts in the inside! We all need a "feel good" moment or to be told that we are appreciated for who we are and what we do. Children need to have these special moments also! Explore new ideas on how to replace the phrase "good job," with new and exciting ways to celebrate children, parents, and staff. Maximize ways to use your daily observations as an opportunity to identify and communicate "YES" moments to build self-esteem by using fresh creative ideas with new-fangled language.

Program Track: Management and Leadership

Target Audience: Administrators, Directors, Teachers: New and Experienced, Training and Technical Staff

Domain (Standard): Approaches to Learning
Social and Emotional Development

Core Competencies: Teaching and Learning Environments and Interactions
Professionalism

Presenter(s):

LuAnn La Cava, Curriculum Specialist
Early Learning Coalition of Pasco and
Hernando Counties, Inc.
15506 County Line Road
Spring Hill, FL 34610

Phone: 727-233-8291 ext. 104
FAX: 727-856-4728
E-Mail: l.lacava@phelc.org

95. Desert To Dessert - Discover The Power Of Your Outdoor Environment

Garrison I-III

Research supports the critical need for young children to learn in rich, natural environments. This session focuses on how teachers and directors can enhance their outdoor play space into a "playscape". Participants will leave this session with inexpensive ideas and simple strategies to turn their "playground" into lush learning centers that promote a child's higher order thinking.

Program Track: Child Growth and Development

Target Audience: Directors, Teachers: New and Experienced

Domain (Standard): Physical Development
Approaches to Learning
Social and Emotional Development
Language, Communication and Emergent Literacy
Cognitive Development and General Knowledge

Core Competencies: Child Development and Learning
Teaching and Learning Environments and Interactions

FRIDAY, JULY 22, 2011

10:15 A.M. - 11:45 A.M.

Presenter(s):

Lynne Eldridge, *Executive Director*
Early Learning Coalition of Northwest Florida
703 West 15th Street, Suite A
Panama City Beach, FL 32401

Phone: 850-747-5400
FAX: 850-747-5450
E-Mail: lynne.eldridge@elcofnwflorida.org

FRIDAY, JULY 22, 2011

12:00 NOON-1:30 P.M. CLOSING GENERAL SESSION

Regency II

Presiding: Theodore G. Granger
Chair, One Goal Summer Conference
Tallahassee, Florida

Keynote Speaker: Pamela C. Phelps, Ph.D.
Consultant for Creative Center for Childhood Research &
Training, Inc., Director of The Creative Pre-School
Tallahassee, FL



Pamela C. Phelps, Ph.D., has over forty years experience working with young children and their families. For nine years, she taught kindergarten and first grade in the public schools of Wakulla and Leon Counties in the state of Florida. For the past thirty years, she has been the Owner/Director of the Creative Pre-School, providing care for approximately one hundred and thirty children, ages two months to six years, on a full day, year round basis. Creative has been chosen as a national and state model for the inclusion of young children with disabilities; continuously nationally accredited since 1989; and “A Gold Seal” program in the state of Florida. It is also the home of The Creative Pre-School Model Program Curriculum: Curriculum: Beyond Centers and Circle Time[®].

Dr. Phelps is the Vice-President of The Creative Center for Childhood Research and Training, a non-profit corporation, providing training and program consultation for adults working with young children. CCCRT conducts and supports research, and makes presentations to professional and non-professional groups on a variety of subjects concerning young children and their families. Dr. Phelps is an international consultant on early childhood education to the Republic of Indonesia, and has conducted multiple national symposiums and workshops in that country. She is active in local, state, and national professional organizations. Dr. Phelps works as an advocate for young children and their families on both the state and national level. She is past chair of the State of Florida’s Coordinating Council for Early Childhood Services appointed by the Commissioner of Education for the State of Florida and a past member of The Florida Interagency Council for Infants and Toddlers. Dr. Phelps has published articles in professional early childhood and special education journals; directed research in early childhood settings; and regularly conducts workshops for educators and parents on play and play environments, behavior management, and numerous other topics related to young children. During the fall of 1992, she was recognized as Volunteer of the Year by The Florida Association of Volunteer for Caribbean Action and as the Child Care Advocate of the Year for her work on behalf of young children by Big Ben Community Coordinated Child Care. In March of 1994, she was chosen Public Citizen fo the Year by The Big Bend Unit of the National Association of Social Workers, Inc.; in May of 1998, she received The Outstanding Women Award from the Tallahassee Branch of the American Association of University women; and in August of 2002, she was presented with the Research in Education Award by the Florida State University chapter of Phi Delta Kappa. Most recently, the Tallahassee 25 recognized Dr. Phelps as a “Superhero” for her dedication and commitment to children.

Phone: 850-422-1080, E-Mail: ccprt@comcast.net

**2011 SUMMER CONFERENCE
ONE GOAL: BUILDING THE FUTURE TOGETHER
“PUTTING FAMILIES AND CHILDREN FIRST”**

JULY 20-22, 2011

COMMERCIAL EXHIBITORS

American Fund Raising Co., Inc.

Jerry Averkamp
216 20th Street West
Bradenton, FL 34205
941-746-4556

Argosy University

Zoy Dell, Dr. Jeannie Peterson
1403 North Howard Avenue
Tampa, FL 33607
813-463-7121
zdell@argosy.edu

Becker's School Supplies

Pat Scorzetti, Jr.
8252 Neda Street
Spring Hill, FL 34606
352-293-1943
pat.scorzetti@cjbinc.com

Block Insurance

Beth Block
Post Office Box 623188
Oviedo, FL 32762
407-365-4775
beth@blockinsurance.net

Branagh Information Group

Tricia Sifford
1513 Baythorn Drive
Wesley Chapel, FL 33543
813-973-8855
tricia.sifford@ersdata.com

Clay Spirit Studios, Inc.

Kevin Ritter
Post Office Box 530725
St. Petersburg, FL 33747
727-323-5412
www.clayspirit.com
kevin@clayspirit.com

Discount School Supply

Joanne Rein
10417 Mount Dora Street
New Port Rickey, FL 34655
727-389-5236
jrein@discountschools Supply.com

Fun Science Materials

Andrea Alexander
170 Lindbergh Drive
Atlanta, GA 30305
404-579-8030
funsience@mindspring.com

Kaplan Corporation

Brad Kaplan, Roxanne Keele,
Bill Wright, Tom Dodd
Post Office Box 609
Lewisville, NC 27023-0609
800-334-2014
www.kaplanco.com

Lakeshore Learning Materials

Scotty Kubin
2695 East Dominguez Street
Carson, CA 90895
800-421-5354
www.lakeshorelearning.com

Nemours BrightStart! Dyslexia Initiative

Kathy Ingram
841 Prudential Drive, Suite 1600
Jacksonville, FL 32207
904-697-3156
bblackar@nemours.org

Oasis Publications

Dianne Warren, Rodney Warren
2344 Canbridge Drive
Sarasota, FL 34232
941-371-2223
dianne@fitness4kidz.com

Rasmussen College

Lauren Drakes, Gary Lomar, Chris Young,
Megan Frey
8661 Citizens Drive, Suite 300
New Port Richey, FL
727-942-0069, ext. 4985
laurne.drakes@rasmussen.edu

School Specialty

Rebecca Bloomfield, Rod Stanford,
Gigi Palmer, Dan Parravano,
Jennifer Gilman, Jennifer LaCourse,
Janet Ranaldi, Susan Harrison
W6316 Design Drive
Greenville, WI 54942
888-388-3224

Smart Horizons

Gabriel Smith
25 East 9 ½ Ride Road
Pensacola, FL 32534
850-465-4016
kmtilley@smarthorizons.org

Teaching Strategies, Inc.

Lorene Sernett
7101 Wisconsin Avenue, Suite 700
Bethesda, MD 20814
301-634-0818
litalk@teachingstrategies.com

Union Institute & University

Josefina Rosario, Francis Francois
16853 N.E. 2nd Avenue
Miami, FL 33162
305-653-9690
josefina.rosario@myunion.edu
www.myunion.edu

Veracity Payments

Scott Wheeler, Tony Walsh
4715 Carroway Drive
Land O Lakes, FL 34639
813-409-6017
scott.wheeler@veracitypayments.com

Walden University

Lindsey Reynolds, Rondey Hockenberry
7998 Clementine Drive
Boynton Beach, FL 33436
561-281-4193
lindsey.reynolds@waldenu.edu

PROGRAM PRESENTERS

| PRESENTERS | DESCRIPTION # | PRESENTERS | DESCRIPTION # |
|---------------------------|---------------|------------------------|---------------|
| Adinolfi, Suzanne | 10,46 | Garcia, Lou | 16 |
| Altman, Miriam | 28 | Gellens, Suzanne | 84 |
| Ampudia, Sandra | 7,63 | Ghazvini, Alisa | 21,26,91 |
| Arnold, Angie | 33 | Gilyard, Jr, Shelton | 49 |
| Babcock, Florie | 8 | Granger, Theodore | 26 |
| Bee, Noelle | 66 | Greenberg, Stuart | 26 |
| Beebe, Polly | 90 | Greenstein, Linda | 35 |
| Benjoseph, Cherie | 40 | Griffith, Naomi Haines | 1 |
| Bernath, Penny | 39 | Hayes, LaToya | 59 |
| Birken, Brittany Olivieri | 26,93 | Haywood, Anne | 50 |
| Blank, Helen | 3 | Hibbard, Marilyn | 29,85 |
| Block, Beth A. | 4 | Hollingsworth, Pamela | 88 |
| Bohorques, Desiree | 63 | Hudson, Claire | 45 |
| Bradshaw, Melissa | 33 | Huffstutler, Barbara | 72 |
| Burns, Elizabeth | 64 | Huls, Tara | 34,48,62 |
| Cabrera, Maria | 28 | Jenkins, Penny | 59 |
| Carter, Kiki | 44 | Jones, Priscilla | 32 |
| Chambers, Sheila B. | 72 | Kalifeh, Phyllis | 15,26,79 |
| Clements, Melissa | 15 | Kendig, Paula | 58 |
| Conner, Damaris | 37 | Krosky, Cynthia | 14,61 |
| Copp, Lilli | 26 | La Cava, LuAnn | 94 |
| Cotto, Luis | 28 | Lawrence, Dianne | 42 |
| Davis, Nancy Lenzen | 43,57 | Leinfelder, Jesse | 15 |
| DiPietrantonio, Tina | 12 | Lister, Patty | 38 |
| Donovan, Susan | 58 | Lloyd, Lina | 76,87 |
| Douglas, Kathy | 36 | Long, Lou Ann | 67,77 |
| Edwards, Sally | 22,83 | Luther, Ginny | 24 |
| Eldridge, Lynne | 31,95 | Maier, Heidi | 82 |
| Elswood, Ruth | 68 | Malecki Claudia | 42 |
| Engisch, Brett | 78 | Malone, Prisha | 64 |
| Engstrom, Brenda | 71 | Mathur, Smita | 80 |
| Ettehadia, Sheila | 9,20 | McConkey, Linda | 9,20 |
| Exline, Candy | 42 | McConnell, Cindy | 19 |
| Faber, Jennifer | 17,79 | McLemore, Bronwyn | 13 |
| Farber, Marilyn | 56 | Mead, Jennifer | 35 |
| Figueroa, Yolanda | 6 | Meyerholtz, Vera | 51 |
| Fischer, Bambi | 6 | Nasche, Gerie | 85,29 |
| Fondacaro, Marjorie | 72 | Nowak, Dawn | 45 |
| Ford, Bettianne | 58 | Orlowski, Tara | 54,81 |
| Franck, Edwiygh | 91 | Pentz, Keith | 73 |
| Franze, Denise | 2 | Pepo, Kelly | 50 |
| Fredebaugh, Dana | 18,69 | Phelps, Pamela C. | 12,23 |

PRESENTERS DESCRIPTION #

| | |
|-------------------------|----------|
| Pintacuda, Larry | 79 |
| Ragbeer, Dianna | 26 |
| Raimondo, Betty | 65 |
| Rajan, Padma | 88 |
| Richardson, Janie W. | 89 |
| Ruiz, Marilyn | 41 |
| Russo, Darcy | 53 |
| Russo, Deborah | 26,55 |
| Sands, Bethany | 7,25,92 |
| Schleig, Elisa | 59 |
| Scott, Stephanie | 92 |
| Selmi, Connie | 5 |
| Serra, Maria | 28 |
| Shermett, Terri | 30 |
| Shuman-Smith, Sartura | 27 |
| Smith, Haylie | 67 |
| Smith, Linda K. | 11 |
| Smith, Lois | 5 |
| Soto, Alina | 25 |
| Stannard, Laura L. | 74 |
| Stegmeyer, Lori | 44 |
| Stone, Charis | 86 |
| Stone, Dottie | 86 |
| Thompson, Gayla | 70 |
| Toscano, Lisa | 2 |
| Vosbrink, Pam | 45 |
| Watson, Michele | 26,52 |
| Weber, Cheryl Fox | 47 |
| Webster, Melinda | 34,48,62 |
| Wells, David | 53 |
| Whitaker, Donna | 46,60 |
| Winterbottom, Christian | 64 |
| Woten, Suzette | 90 |

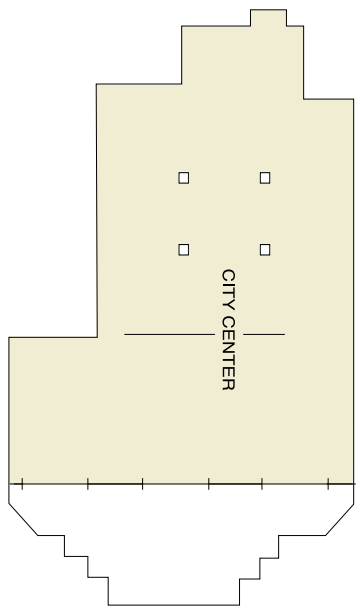

LOBBY LEVEL

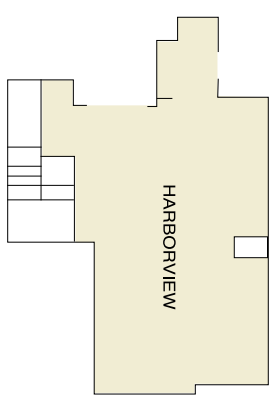

SIXTEENTH FLOOR

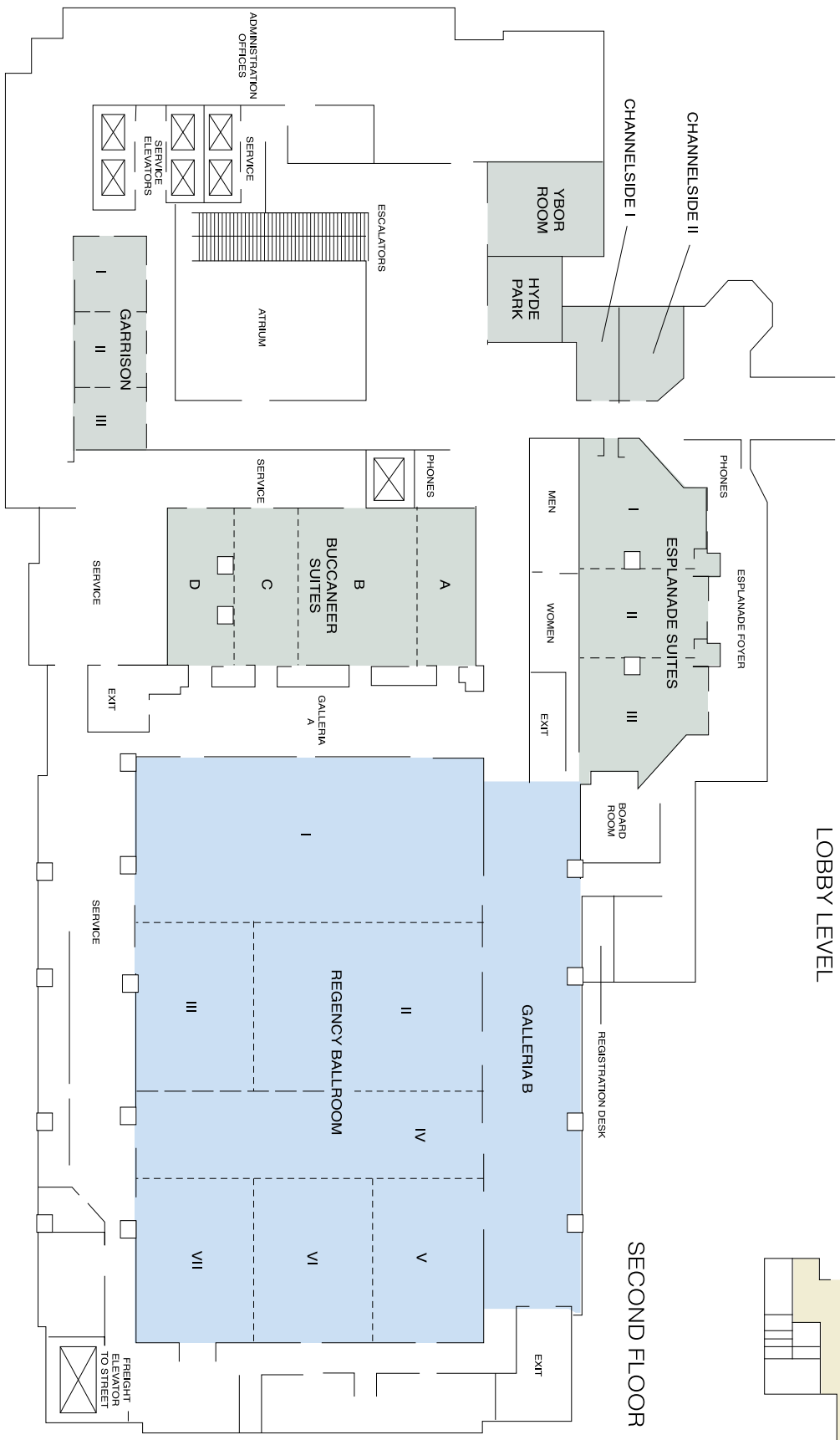

SECOND FLOOR